

**A Map of West Part Of Lot No. 15 in Great Lot No. 35 of the Hardenbergh Patent
situate in the town of Hancock in Delaware County**

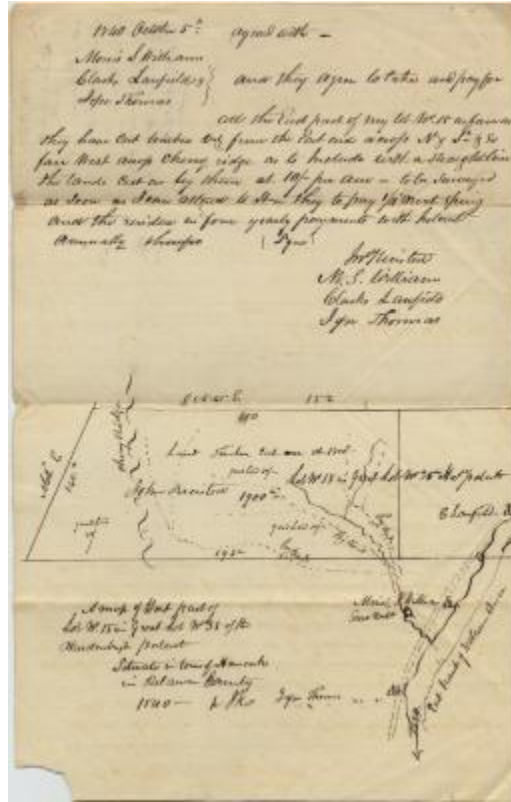

A map of the west part of Lot No. 15 in Great Lot No. 35 of the Hardenbergh Patent situated in the Town of Hancock, Delaware County in the Catskill Mountain region. Scale indeterminable. This map includes a survey.

Identifier

NYSL SC17820 B3 F14

Alternate Identifier

DMS ID Number: 117552

Date _____

1840

Repository

New York State Library

Source

New York State Library, John Kiersted Family papers, SC17820, Box 3, folder 14.

Rights

This record is not part of the New York State Archives' collection and is presented on our project partner's behalf for educational use only. Please contact the home repository for information on copyright and reproductions.

More From This Series

John Kiersted Family papers

Geographic Locations

Delaware County (is associated with)