

Maps of several tracts of land in the County of Montgomery. Map #90

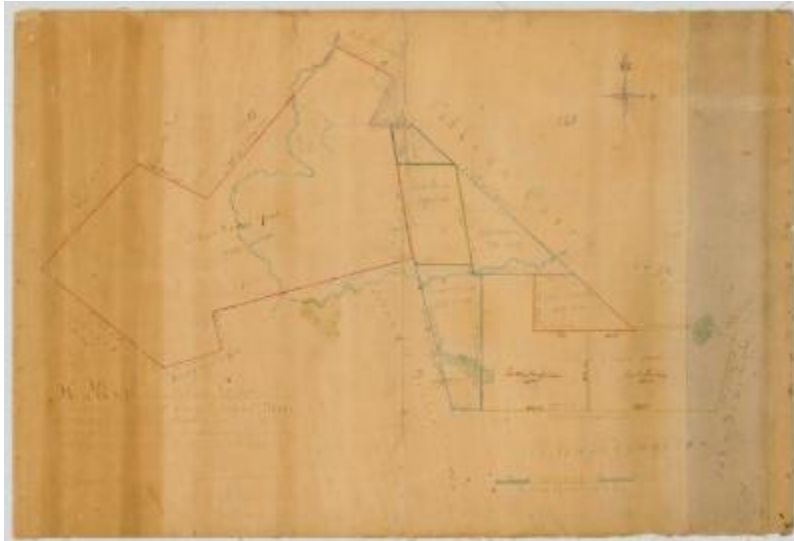

Maps of several tracts of land, situate in the County of Montgomery, on the south side of the Mohawk river, about two miles and a half southwesterly from Corry Town. Surveyed by Lawrence Vrooman, Deputy Surveyor. Dated July 20th, 1787. [Montgomery and Schoharie Counties]

Identifier

NYSA_A0273-78_90

Alternate Identifier

DMS ID Number: 182937

Date

July 20 1787

Repository

New York State Archives

Source

New York State Archives. New York (State). State Engineer and Surveyor. Survey maps of lands in New York State, ca. 1711-1913. Series A0273-78, Map #90.

Rights

This image is provided for education and research purposes. Rights may be reserved. Responsibility for securing permissions to distribute, publish, reproduce or other use rest with the user. For additional information see our [Copyright and Use Statement](#)

More From This Series

Survey maps of lands in New York State

Geographic Locations

Montgomery County (is associated with)

Schoharie County (is associated with)