

Map of a patent of William Markham, Duncan Campbell and Thomas Hobson. Map #172

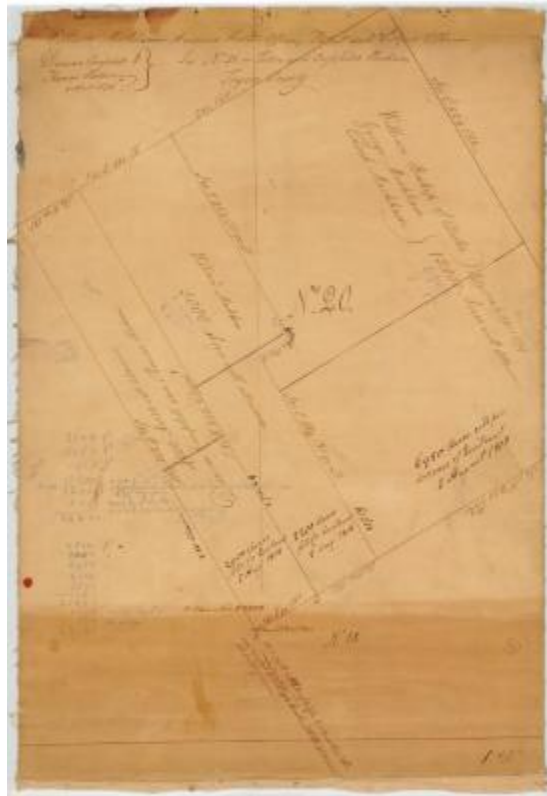

Map of a patent of William Markham, Duncan Campbell and Thomas Hobson.

Identifier

NYSA_A0273-78_172

Alternate Identifier

DMS ID Number: 183677

Date

April 5 1774

Repository

New York State Archives

Source

New York State Archives. New York (State). State Engineer and Surveyor. Survey maps of lands in New York State, ca. 1711-1913. Series A0273-78, Map #172.

Rights

This image is provided for education and research purposes. Rights may be reserved. Responsibility for securing permissions to distribute, publish, reproduce or other use rest with the user. For additional information see our [Copyright and Use Statement](#)

More From This Series

Survey maps of lands in New York State

Geographic Locations

New York (is associated with)