

## Map of Correy's Patent

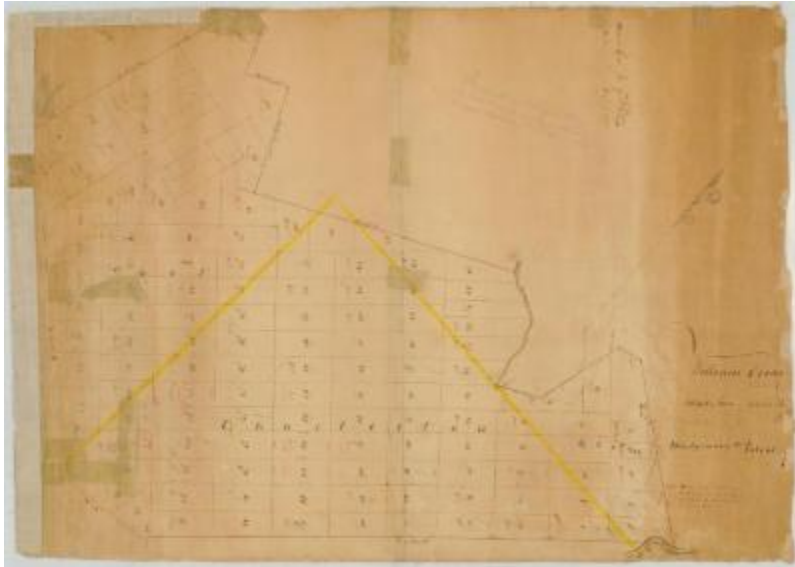

Map of Correy's Patent in Montgomery County and Schoharie county. The patent was awarded to William Corry [sic] and others in 1737. The map is composed of paper mounted on a linen backing. Adhesive tape had been used by the State Comptroller's Office to repair the map. This tape has been left in place.;The map was removed from its wooden mounting for scanning. It was placed in a protective polyester (Mylar) folder, so moirés (or Newton's rings) are present, particularly at the edge of the digital image.

### Identifier

NYSA\_B1610-99\_90

### Alternate Identifier

DMS ID Number: 177549

### Date

circa 1737

### Repository

New York State Archives

### Source

New York State Archives, New York (State). Comptroller's Office. Maps of undivided tracts and of tracts sold by the comptroller for unpaid taxes, ca. 1700-1935. Series B1610-99, Map 90.

### Rights

This image is provided for education and research purposes. Rights may be reserved. Responsibility for securing permissions to distribute, publish, reproduce or other use rest with the user. For additional information see our [Copyright and Use Statement](#)

### More From This Series

Maps of undivided tracts and of tracts sold by the comptroller for unpaid taxes

### Geographic Locations

Montgomery County (is associated with)

Schoharie County (is associated with)