



**Brown Station Nursery Catskill (NYSA\_14297-87\_1513)**

---



**Catskill Mts. Sugar Loaf Mt. View from Platte Clove (NYSA\_14297-87\_2278)**

---



**Jas S. Whipple, Com'r of Forest, Fish and Game on logs (NYSA\_14297-87\_4414)**

---



**On the rocky brow of Haines Falls (NYSA\_14297-87\_B260\_57L517LAN)**

---



**Letter from H. E. Ganung, Surveyor, to the New York State Water Supply Commission (NYSA\_16828-01\_B01\_F63\_7)**

---



**Water Supply Commission survey questionnaire for the Village of Catskill (NYSA\_16828-01\_B03\_F20)**

---



**Ordinances, Rules and Regulations of the Catskill Water Works (NYSA\_16828-01\_B03\_F20\_2)**

---



**Water Supply Commission survey questionnaire for the City of Kingston (NYS 16828-01\_B07\_F32)**



**State highway, Phoenicia-Stony Clove (NYS 17672-92\_B02\_Dr7\_19480603\_001)**



**State highway, Phoenicia-Stony Clove (NYS 17672-92\_B02\_Dr7\_19480603\_002)**



**Catskill Highway, Palenville (NYS 17672-92\_B02\_Dr7\_19490602\_001)**



**Catskill Highway, Palenville (NYS 17672-92\_B02\_Dr7\_19490602\_002)**



**New York Route 23, Prattsville-Ashland and Ashland-Windham (NYS 17672-92\_B30\_4500\_1)**



**Catskill Thruway progress photograph (NYS 17672-92\_B30\_4511\_7)**



**New York Route 23, Prattsville-Ashland and Ashland-Windham (NYS 17672-92\_B31\_4654\_6)**



**Palenville-Catskill, state highway 8231 (NYSA\_17672-92\_B32\_4955\_4)**

---



**Palenville-Catskill, state highway 8231 (NYSA\_17672-92\_B32\_4955\_5)**

---



**Palenville-Catskill, state highway 8231 (NYSA\_17672-92\_B32\_4955\_9)**

---



**Palenville-Catskill, state highway 8231 (NYSA\_17672-92\_B32\_4955\_12)**

---



**Rock slide, Catskill Thruway (NYSA\_17672-92\_B34\_5464\_2)**

---



**Cooksburg-Cairo, parts 1 and 2 (NYSA\_17672-92\_B38\_6154\_6)**

---



**Highway construction at Haines Falls, Hunter, NY (NYSA\_17672-92\_B39\_6386\_5)**

---



**Highway construction at Haines Falls, Hunter, NY (NYSA\_17672-92\_B39\_6386\_7)**

---



**Stony Clove, part 1, Phoenicia to Kaaterskill Junction (NYS A\_17672-92\_B42\_6799\_14)**



**Stony Clove, part 1, Phoenicia to Kaaterskill Junction (NYS A\_17672-92\_B42\_6815\_2)**



**Cairo to Windham part 1, Cooksburg to Cairo part 3, etc. (NYS A\_17672-92\_B49\_7645\_2)**



**Windham part 2, Cairo to Windham part 4, Cairo to Windham part 3 (NYS A\_17672-92\_B49\_7682\_4)**



**Greenville to Coxsackie, parts 2 and 3 (NYS A\_17672-92\_B51\_7983\_4)**



**Fireplace in the house of Dirk Van Veghten in Old Ford on Catskill Creek (NYS A\_0245-77\_Greene\_B04\_44)**



**Map of unappropriated lands southward and eastward of Dies's Manor. Map #165 (NYS A\_0273-78\_165)**



**Map of the Patents of Catskill, Windham, etc. Map #195 (NYS A\_0273-78\_195)**



**Map of the different lines run for the third tract of the Vanbergen Patent. Map #213 (NYSA\_A0273-78\_213)**

---



**Map of unappropriated Lands in the Towns of Windham, Catskill, Canton and Freehold. Map #216B (NYSA\_A0273-78\_216B)**

---



**Map of the Town of Catskill, Green County. Map #369A (NYSA\_A0273-78\_369A)**

---



**Map of the Town of Catskill, Greene County. Map #369B (NYSA\_A0273-78\_369B)**

---



**Map of the Town of Freehold in Albany County. Map #396 (NYSA\_A0273-78\_396)**

---



**Map of the Town of Coxsackie, Green County. Map #420 (NYSA\_A0273-78\_420)**

---



**Survey of land for Martin G. Van Buren, 14,969 acres and 3 pieces for Vincent Mathews and others. Map #715 (NYSA\_A0273-78\_715)**

---



**New York. Taking Toll at an Old-Time Tollgate. Climax, N.Y.  
(NYS\_A3045-78\_10513)**

---



**Sugarloaf Mt. from near Tannersville (NYS\_A3045-78\_D47\_CcS8)**

---



**Map of the Hudson River, section no. 4, Kingston to Coxsackie  
(NYS\_A3045-78\_D47\_Hu4)**

---



**Map of the Hudson River, section no. 5, Coxsackie to Albany and  
mouth of Mohawk River (NYS\_A3045-78\_D47\_Hu5)**

---



**New York. Near Catskill. Cement plant. Alsen, Greene Co.  
(NYS\_A3045-78\_Dn\_Cdc9)**

---



**Map of Northern Section of New York City Water Supply System.  
From J.R. Smith's "Human Geography," Book I. Copyright, 1924, The  
John C. Winston Company (NYS\_A3045-78\_Dn\_N7)**

---



**Catskill Aqueduct (NYS\_A3045-78\_P8498)**

---



**Panorama from Old Mt. House across Hudson R. to Berkshires  
(NYS A3045\_1265)**

---



**Schoharie River, near Tannersville, showing Round Top & High Peak  
(NYS A3045\_1339)**

---



**Devasego Falls - Schoharie River (NYS A3045\_1362)**

---



**Old Stone Bridge over the Catskill Creek (NYS A3045\_10646)**

---



**Virgin Spruce Forest Close to Highway. Kaaterskill park, Greene co.  
[sic] N.Y. (NYS A3045\_A10651)**

---



**Upper Kaaterskill Falls (NYS A3045\_A10652)**

---



**Haines Falls from Near Tennis Court of Twilight Park  
(NYS A3045\_A10656)**

---



**Catskill Mountain House; Hudson Valley in Distance  
(NYSA\_A3045\_B14465)**

---



**Kaaterskill Hotel from Mountain Road (NYSA\_A3045\_D47\_CcK5)**

---



**Kaaterskill Falls. Winter Icicles (NYSA\_A3045\_D47\_CcK21)**

---



**Kaaterskill Falls, Winter, Icicles (NYSA\_A3045\_D47\_CcK22)**

---



**Map of Lockerman Tract in Ulster County (NYSA\_B1773-01\_B3\_F25)**

---



**Survey of lands under water for Samuel & Oliver Wiswall, Lemuel W.  
Sears (NYSA\_B2321-11\_18040126\_Wiswall\_and\_Sears)**

---



**Survey of lands under water for Isaac Wells (NYSA\_B2321-  
11\_18061129\_Wells)**

---





**Survey of lands under water for Paul Bunker, et al (NYSA\_B2321-11\_18110426\_Bunker\_etal)**



**Survey of lands under water for John Livingston (NYSA\_B2321-11\_18130319\_Livingston)**



**Survey of lands under water for John Dubois (NYSA\_B2321-11\_18140808\_Dubois)**



**Survey of lands under water for Isaac Wells, Edward Wells & David Sharp (NYSA\_B2321-11\_18150810\_Wells-Sharp)**



**Survey of lands under water for William Schuneman (NYSA\_B2321-11\_18160531\_Schuneman)**



**Survey of lands under water for Roswell Reed & William Well (NYSA\_B2321-11\_18161217\_Reed-Wells)**



**Survey of lands under water for Anthony Van Bergen (NYSA\_B2321-11\_18290509\_Van\_Bergen\_01)**



**Survey of lands under water for Anthony Van Bergen (NYSA\_B2321-11\_18290509\_Van\_Bergen\_02)**

---



**Survey of lands under water for Charles Bartlett (NYSA\_B2321-11\_18300915\_Bartlett)**

---



**Survey of lands under water for William Kirtland, Ebenezer Barker & William D. Kirtland (NYSA\_B2321-11\_18450508\_Kirtland-Barker-Kirtland)**

---



**Survey of lands under water for Leonard Haight (NYSA\_B2321-11\_18520402\_Haight)**

---



**Survey of lands under water for Henry Cooper (NYSA\_B2321-11\_18540427\_Cooper)**

---



**Survey of lands under water for Barent Hotaling (NYSA\_B2321-11\_18540428\_Hotaling)**

---



**Survey of lands under water for Hiram Brown (NYSA\_B2321-11\_18630929\_Brown)**

---



**Survey of lands under water for George C. Hubbel (NYSA\_B2321-11\_18661227\_Hubbel)**

---



**Survey of lands under water for Herman C. & William R. Adams (NYSA\_B2321-11\_18670807\_Adams)**

---



**Survey of lands under water for Mary A. Adams, Mary A. Morford & Ada Morford (NYSA\_B2321-11\_18670807\_Adams-Morford-Morford)**

---



**Survey of lands under water for Daniel R. Palmatier (NYSA\_B2321-11\_18670807\_Palmatier)**

---



**Survey of lands under water for Joel W. Porter (NYSA\_B2321-11\_18670807\_Porter)**

---



**Survey of lands under water for Henry Stranahan (NYSA\_B2321-11\_18670807\_Stranahan)**

---



**Survey of lands under water for David Whiting (NYSA\_B2321-11\_18680312\_Whiting)**

---



**Survey of lands under water for Knickerbocker Ice Company (NYSA\_B2321-11\_18690524\_Knickerbocker\_Ice\_Co\_01)**

---



**Survey of lands under water for Knickerbocker Ice Company  
(NYSA\_B2321-11\_18690524\_Knickerbocker\_Ice\_Co\_02)**



**Survey of lands under water for George C. Hubbell (Richard Martin)  
(NYSA\_B2321-11\_18690612\_Hubbell\_Martin)**



**Survey of lands under water for Washington Ice Company  
(NYSA\_B2321-11\_18690612\_Washington\_Ice\_Co)**



**Survey of lands under water for Washington Ice Co. & Zion Lutheran  
Church (NYSA\_B2321-11\_18691020\_Washington\_Ice\_Co-  
Zion\_Lutheran\_Church)**



**Survey of lands under water for Knickerbocker Ice Company  
(NYSA\_B2321-11\_18711209\_Knickerbocker\_Ice\_Co)**



**Survey of lands under water for Consumers Ice Company  
(NYSA\_B2321-11\_18721119\_Consumers\_Ice\_Co\_01)**



**Survey of lands under water for Minot F. Winch (NYSA\_B2321-  
11\_18730404\_Winch)**



**Survey of lands under water for Hudson River Towing Co.  
(NYSA\_B2321-11\_18730802\_Hudson\_River\_Towing\_Co)**

---



**Survey of lands under water for Knickerbocker Ice Company  
(NYSA\_B2321-11\_18730802\_Knickerbocker\_Ice\_Co)**

---



**Survey of lands under water for Knickerbocker Ice Company  
(NYSA\_B2321-11\_18731006\_Knickerbocker\_Ice\_Co)**

---



**Survey of lands under water for George S. Nichols, et al  
(NYSA\_B2321-11\_18731006\_Nichols)**

---



**Survey of lands under water for Haight, George & Caroline  
(NYSA\_B2321-11\_18741124\_Haight\_01)**

---



**Survey of lands under water for Haight, George & Caroline  
(NYSA\_B2321-11\_18741124\_Haight\_02)**

---



**Survey of lands under water for Vanderpoel, Andrew J. (NYSA\_B2321-11\_18741222\_Vanderpoel)**

---



**Survey of lands under water for Maria Cole et al (NYSA\_B2321-11\_18770321\_Cole\_01)**

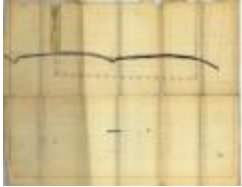

**Survey of lands under water for Maria Cole et al (NYSA\_B2321-11\_18770321\_Cole\_02)**

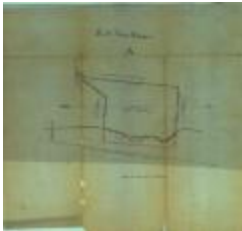

**Survey of lands under water for Burchell, Mary J. (NYSA\_B2321-11\_18781120\_Burchell\_01)**



**Survey of lands under water for Burchell, Mary J. (NYSA\_B2321-11\_18781120\_Burchell\_02)**



**Survey of lands under water for Brown, Hiram (NYSA\_B2321-11\_18790102\_Brown\_01)**



**Survey of lands under water for Brown, Hiram (NYSA\_B2321-11\_18790102\_Brown\_02)**



**Survey of lands under water for Rittenhouse, Stacy B. (NYSA\_B2321-11\_18790531\_Rittenhouse\_01)**



**Survey of lands under water for Rittenhouse, Stacy B. (NYSA\_B2321-11\_18790531\_Rittenhouse\_02)**



**Survey of lands under water for Joseph & Samuel Stephens (NYSA\_B2321-11\_18790624\_Stephens\_01)**



**Survey of lands under water for Joseph & Samuel Stephens (NYSA\_B2321-11\_18790624\_Stephens\_02)**



**Survey of lands under water for Adam, Francis G. (NYSA\_B2321-11\_18791018\_Adam\_01)**



**Survey of lands under water for Adam, Francis G. (NYSA\_B2321-11\_18791018\_Adam\_02)**



**Survey of lands under water for Bronk, Maria (NYSA\_B2321-11\_18791024\_Bronk\_01)**



**Survey of lands under water for Bronk, Maria (NYSA\_B2321-11\_18791024\_Bronk\_02)**



**Survey of lands under water for Bronk, Maria (NYSA\_B2321-11\_18791024\_Bronk\_03)**

---



**Survey of lands under water for Horton Ice Cream Co. (NYSA\_B2321-11\_18800707\_Horton\_Ice\_Cream\_01)**

---



**Survey of lands under water for Horton Ice Cream Co. (NYSA\_B2321-11\_18800707\_Horton\_Ice\_Cream\_02)**

---



**Survey of lands under water for Geoghegan, Thomas (NYSA\_B2321-11\_18800921\_Geoghegan\_01)**

---



**Survey of lands under water for Geoghegan, Thomas (NYSA\_B2321-11\_18800921\_Geoghegan\_02)**

---



**Survey of lands under water for Lampman, Adelaide B. (NYSA\_B2321-11\_18800921\_Lampman\_01)**

---



**Survey of lands under water for Lampman, Adelaide B. (NYSA\_B2321-11\_18800921\_Lampman\_02)**

---





**Survey of lands under water for Garrison Palmer, Charles Bogardus, Horace Palmer & Arthur E. Powell (NYSA\_B2321-11\_18800921\_Palmer-Bogardus-Powell\_01)**



**Survey of lands under water for Garrison Palmer, Charles Bogardus, Horace Palmer & Arthur E. Powell (NYSA\_B2321-11\_18800921\_Palmer-Bogardus-Powell\_02)**



**Survey of lands under water for Ruth Ann Stone & Margaret E.Wood (NYSA\_B2321-11\_18800921\_Stone-Wood\_01)**



**Survey of lands under water for Ruth Ann Stone & Margaret E.Wood (NYSA\_B2321-11\_18800921\_Stone-Wood\_02)**



**Survey of lands under water for John Clark & John Van Slyke (NYSA\_B2321-11\_18810414\_Clark-VanSlyke\_01)**



**Survey of lands under water for John Clark & John Van Slyke (NYSA\_B2321-11\_18810414\_Clark-VanSlyke\_02)**



**Survey of lands under water for Sanders, James (NYSA\_B2321-11\_18810714\_Sanders\_01)**



**Survey of lands under water for Sanders, James (NYSA\_B2321-11\_18810714\_Sanders\_02)**



**Survey of lands under water for Cheney's Towing Line (NYSA\_B2321-11\_18811115\_Cheney's\_Towing\_Line\_01)**



**Survey of lands under water for Cheney's Towing Line (NYSA\_B2321-11\_18811115\_Cheney's\_Towing\_Line\_02)**



**Survey of lands under water for Joseph Hallock (NYSA\_B2321-11\_18820119\_Hallock\_01)**



**Survey of lands under water for Joseph Hallock (NYSA\_B2321-11\_18820119\_Hallock\_02)**



**Survey of lands under water for Robert Seaman (NYSA\_B2321-11\_18820119\_Seaman\_01)**



**Survey of lands under water for Robert Seaman (NYSA\_B2321-11\_18820119\_Seaman\_02)**



**Survey of lands under water for Jane V. & Josephine Hopkins (NYSA\_B2321-11\_18820413\_Hopkins\_01)**



**Survey of lands under water for Jane V. & Josephine Hopkins (NYSA\_B2321-11\_18820413\_Hopkins\_02)**



**Survey of lands under water for James E. Bronk (NYSA\_B2321-11\_18820525\_Bronk\_01)**



**Survey of lands under water for James E. Bronk (NYSA\_B2321-11\_18820525\_Bronk\_02)**



**Survey of lands under water for National Ice Company of NY (NYSA\_B2321-11\_18820525\_National\_Ice\_Co\_of\_NY\_01)**



**Survey of lands under water for National Ice Company of NY (NYSA\_B2321-11\_18820525\_National\_Ice\_Co\_of\_NY\_02)**



**Survey of lands under water for National Ice Company of NY (NYSA\_B2321-11\_18820525\_National\_Ice\_Co\_of\_NY\_03)**



**Survey of lands under water for Harris Manufacturing Company Ltd. (NYSA\_B2321-11\_18821002\_Harris\_Manufacturing\_Company\_Ltd\_01)**



**Survey of lands under water for Harris Manufacturing Company Ltd. (NYSA\_B2321-11\_18821002\_Harris\_Manufacturing\_Company\_Ltd\_02)**



**Survey of lands under water for Harris Manufacturing Company Ltd. (NYSA\_B2321-11\_18821002\_Harris\_Manufacturing\_Company\_Ltd\_03)**



**Survey of lands under water for Joseph H. Millington & James H. Badeau (NYSA\_B2321-11\_18821002\_Millington-Badeau\_01)**



**Survey of lands under water for Joseph H. Millington & James H. Badeau (NYSA\_B2321-11\_18821002\_Millington-Badeau\_02)**



**Survey of lands under water for Joseph H. Millington & James H. Badeau (NYSA\_B2321-11\_18821002\_Millington-Badeau\_03)**



**Survey of lands under water for Joseph H. Millington & James H. Badeau (NYSA\_B2321-11\_18821002\_Millington-Badeau\_04)**



**Survey of lands under water for Joseph H. Millington & James H. Badeau (NYSA\_B2321-11\_18821002\_Millington-Badeau\_05)**



**Survey of lands under water for U.S.A. (NYSA\_B2321-11\_18821116\_USA\_01)**



**Survey of lands under water for U.S.A. (NYSA\_B2321-11\_18821116\_USA\_02)**



**Survey of lands under water for U.S.A. (NYSA\_B2321-11\_18821116\_USA\_03)**



**Survey of lands under water for James Adams (NYSA\_B2321-11\_18830419\_Adams\_01)**



**Survey of lands under water for James Adams (NYSA\_B2321-11\_18830419\_Adams\_02)**



**Survey of lands under water for Hop-O-Nose Knitting Co. Ltd.  
(NYSA\_B2321-11\_18830419\_Hop-O-Nose\_Knitting\_Co\_Ltd\_01)**

---



**Survey of lands under water for Hop-O-Nose Knitting Co. Ltd.  
(NYSA\_B2321-11\_18830419\_Hop-O-Nose\_Knitting\_Co\_Ltd\_02)**

---

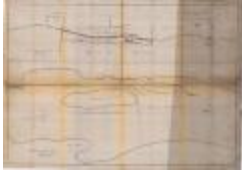

**Survey of lands under water for National Ice Company of New York  
(NYSA\_B2321-11\_18830605\_National\_Ice\_Co\_of\_NY)**

---

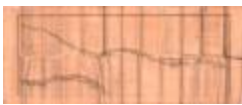

**Survey of lands under water for Harper W. Rogers (NYSA\_B2321-11\_18840506\_Rogers\_01)**

---



**Survey of lands under water for Harper W. Rogers (NYSA\_B2321-11\_18840506\_Rogers\_02)**

---



**Survey of lands under water for Harper W. Rogers (NYSA\_B2321-11\_18840506\_Rogers\_03)**

---



**Survey of lands under water for Harper W. Rogers (NYSA\_B2321-11\_18840506\_Rogers\_04)**

---



**Survey of lands under water for Harper W. Rogers (NYSA\_B2321-11\_18840506\_Rogers\_05)**

---



**Survey of lands under water for Andrew V.S. Vanderpool & Edmund H. Van Orden (NYSA\_B2321-11\_18840805\_Vanderpool-VanOrden\_01)**

---



**Survey of lands under water for Andrew V.S. Vanderpool & Edmund H. Van Orden (NYSA\_B2321-11\_18840805\_Vanderpool-VanOrden\_02)**

---



**Survey of lands under water for The Engineer of the 3rd District  
(Lighthouse Sites) (NYSA\_B2321-11\_18840902\_Engr\_of\_3rd\_Dist\_01)**

---



**Survey of lands under water for The Engineer of the 3rd District  
(Lighthouse Sites) (NYSA\_B2321-11\_18840902\_Engr\_of\_3rd\_Dist\_02)**

---



**Survey of lands under water for The Engineer of the 3rd District  
(Lighthouse Sites) (NYSA\_B2321-11\_18840902\_Engr\_of\_3rd\_Dist\_03)**

---



**Survey of lands under water for James K. Bronk (NYSA\_B2321-  
11\_18850402\_Bronk\_01)**

---



**Survey of lands under water for James K. Bronk (NYSA\_B2321-  
11\_18850402\_Bronk\_02)**

---



**Survey of lands under water for John Colvin (NYSA\_B2321-  
11\_18850901\_Colvin\_01)**

---



**Survey of lands under water for John Colvin (NYSA\_B2321-  
11\_18850901\_Colvin\_02)**

---



**A Survey of Two Pieces of Land Run Off the Southern Part of  
Guysbert Dedericks Farm for Jacob Trumpbour  
(NYSL\_SC7004\_B3\_F11)**

---



**Release. Fredrick Smith [and Sara] his Wife to Nicholas Trump[bour  
and] Elizabeth his Wife, For the Half of Three Lots in the Great [ill]  
(NYSL\_SC7004\_B3\_F15)**

---



**Catskill Mountains (N.Y.) (NYSL\_SC7004\_B3\_F18)**

---



**Map [of] Clarks Bush (NYSL\_SC7004\_B3\_F21)**

---



**[Survey for] Peter Vandebogart - Lot N. 43 in the Subdivision of Lot  
N. 20 Hardenbergh Patent (NYSL\_SC7004\_B6\_F45)**

---



**Letter to John A. Thomson from George A. Lepper  
(NYSL\_SC10637\_B2\_a)**

---



**Draft of a letter to Benjamin F. Greene from John A. Thomson  
[transcript] (NYSL\_SC10637\_B2\_b\_001)**

---



**Draft of a letter to Benjamin F. Greene from John A. Thomson  
[transcript] (NYSL\_SC10637\_B2\_b\_002)**

---



**Draft letter from John A. Thomson to Elizur Goodrich [typescript]  
(NYSL\_SC10637\_B2\_d\_001)**

---



**Draft letter from John A. Thomson to Elizur Goodrich [typescript]  
(NYSL\_SC10637\_B2\_d\_002)**

---



**Draft letter from John A. Thomson to Elizur Goodrich [typescript]  
(NYSL\_SC10637\_B2\_d\_003)**

---



**Draft letter from John A. Thomson to Elizur Goodrich [typescript]  
(NYSL\_SC10637\_B2\_d\_004)**

---



**Account of Catskill Ferry with Nathaniel Jacobs Jr.  
(NYSL\_SC10637\_B3\_a)**

---





**Account of Catskill Ferry with John A. Thomson  
(NYSL\_SC10637\_B3\_b)**

---



**Account of Catskill Horse boat ferry with John A. Thomson  
(NYSL\_SC10637\_B3\_c)**

---



**Statements of Ferry Receipts for 1829 (NYSL\_SC10637\_B3\_d)**

---



**Letter to John A. Thomson from James Rodgers and Moses [Kinyon]  
(NYSL\_SC10637\_B3\_e\_001)**

---



**Letter to John A. Thomson from James Rodgers and Moses [Kinyon]  
(NYSL\_SC10637\_B3\_e\_002)**

---



**Henry Burdens Bill - Horse Boat (NYSL\_SC10637\_B3\_f)**

---



Catskill Mountain Association stock certificate  
(NYSL\_SC10637\_B6\_a)



Catskill Mountain House Association stock certificate  
(NYSL\_SC10637\_B6\_b)

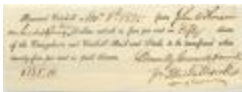

Receipt for Canajoharie and Catskill Railroad stock  
(NYSL\_SC10637\_B6\_c)



Promissory note; Aqueduct Association to Garret Abeel, Esq.  
(NYSL\_SC10637\_B10\_SF)



A survey for John Brandon of two lots of bark sold to Bartow G. Morss[?] & Peeled by him since 1840, No. 2 mostly on the Harnacker Farm, No. 3 mostly on the Expense Lot in Division No. 43 of Great Lot No. 20 of the H[ardenburgh] P[atent] (NYSL\_SC17820\_B3\_F18\_001)



A Map of Eastkill Patent, Greene County, the lands of Daniel McLean and Malachi Tract (NYSL\_SC17820\_B4\_F6)



A Map of Partition of Land near the boundaries of Albany, Greene and Schoharie Counties (NYSL\_SC17820\_B4\_F14)



[Shelter on] Hunter Mt. (NYSL\_SC19469\_B2\_F22\_P3\_c)



[Fire tower on] Hunter Mt. (NYSL\_SC19469\_B2\_F22\_P4)

---



Hunter Mt. (NYSL\_SC19469\_B2\_F22\_P5)

---



Plateau Mt. (NYSL\_SC19469\_B2\_F25\_P7)

---



[View from] Hunter Mt. (NYSL\_SC19469\_B4\_F58\_P2)

---