



NYS hatching house at Caledonia (copy of print) (NYSA_14297-87_1690)



Map of the west, or Water Front of the chief part of the village of Troy. Map #9 (NYSA_A0273-78_9)



Map of Township number 23 and adjacent lands. Totten and Crossfield Purchase. Map #10 (NYSA_A0273-78_10)



Map of two tracts of land called Scaroon Tract and Brant Lake Track. Map #49 (NYSA_A0273-78_49)



Map of unappropriated Land in the town of Westfield in the County of Washington. Map #50A (NYSA_A0273-78_50A)



Map of unappropriated Land in the town of Westfield in the County of Washington. Map #50B (NYSA_A0273-78_50B)



Map of Township Cato (No. 3). Map #103 (NYSA_A0273-78_103)



Map of Great Hardenbergh Patent. Map #140 (NYSA_A0273-78_140)



Map of a part of the late Oneida Reservation. Map #201A (NYSA_A0273-78_201A)



Map of a part of the late Oneida Reservation. Map #201B (NYSA_A0273-78_201B)



A Map of the lands in the Oneida Reservation, 1803 (NYSA_A0273-78_202)



Map of the northwest part of the Oneida Reservation, 1803 (NYSA_A0273-78_203)



Map of the Town of Brookhaven in the County of Suffolk. Map #352B (NYSA_A0273-78_352B)



Map of Westchester. Map #400 (NYSA_A0273-78_400)



Map of the Town of White Plains, Westchester County. Map #404D (Copy) (NYSA_A0273-78_404D)



Map of Onondaga Salt Lake. Map #410 (NYSA_A0273-78_410)



Map of the Town of Kinderhook. Map #411 (NYSA_A0273-78_411)



Map of the Town of Coxsackie, Green County. Map #420 (NYSA_A0273-78_420)



Map of the Township of West Chester. Map #424 (NYSA_A0273-78_424)



Map of Fort Richmond, Staten Island. Map #427 (NYSA_A0273-78_427)



Map of lands adjoining Lake Champlain in Clinton and Essex Counties. Map #428 (NYSA_A0273-78_428)



Map of Phillipstown, Dutchess County. Map #430 (NYSA_A0273-78_430)



Map of the Town of Shawangunk, Ulster County. Map #433 (NYSA_A0273-78_433)



Plan for subdividing the State Lands south of Erie Canal and east of West Street. Map #453 (NYSA_A0273-78_453)



Map of Subdivisions of lands near Church Street, Syracuse. Map #458B (NYSA_A0273-78_458B)



Map of several pieces of land situated in the Town of Bushwick, Kings County. Map #464 (NYSA_A0273-78_464)



Map of Oriskany Patent, Oneida County. Map #465 (NYSA_A0273-78_465)

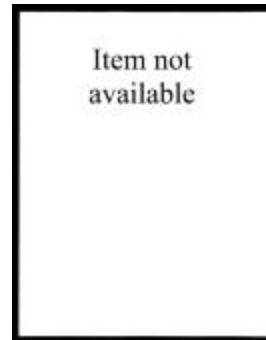

Map of Tompkins County. Map #471 (NYSA_A0273-78_471)



Profile of the Wallkill river at Walden, Orange County. Map #472A (NYSA_A0273-78_472A)



Profile of the Wallkill river at Walden, Orange County. Map #472B (NYSA_A0273-78_472B)



Document with Profile of the Wallkill river at Walden, Orange County. Map #472C (NYSA_A0273-78_472C)



Lake George from original plot. Map #476A (NYSA_A0273-78_476A)



Lake George from original plot. Map #476B (NYSA_A0273-78_476B)



Traverse of Highways, Albany to Fishkill and Newburgh. Map #491 (NYSA_A0273-78_491)



Map of Coarse Salt Lands at Syracuse, N. Y. Map #494 (NYSA_A0273-78_494)



Bluff Point, in Raquette Lake, Hamilton County. Map #500 (NYSA_A0273-78_500)

Item not available

Map of Lake George. 1880. Map #502 (NYSA_A0273-78_502)



Totten and Crossfield's Purchase, Township 40 showing Raquette Lake. Map #503 (NYSA_A0273-78_503)



Totten and Crossfield's Purchase, Township 40 showing Raquette Lake. Map #503A (NYSA_A0273-78_503A)

Item not available

Boundary line between the Towns of Exeter and Burlington. Map #507 (NYSA_A0273-78_507)



Map of Hoyt's Salt Block, 1st Ward, Syracuse. Map #508 (NYSA_A0273-78_508)



Corner Location of Benson Township, Jerseyfield Patent and Lawrence Patent. Map #512 (NYSA_A0273-78_512)



Macomb's Purchase. Great Lot No. 1, Township 20, Franklin County. Map #513 (NYSA_A0273-78_513)



Map of State Land in Buffalo, New York. Map #515 (NYSA_A0273-78_515)



Sempronius, Lot No. 61, Cayuga County. Map #521 (NYSA_A0273-78_521)

Oversized item

Map of Township of Lake Pleasant, Hamilton County. Map #587 (NYSA_A0273-78_587)

Item not available

Map of State Lands, (Ne-ha-sa-ne park) Hamilton and Herkimer Co. Map #588 (NYSA_A0273-78_588)



Survey of Land for Pietrus Van Dreissen and John Van Dreissen. Map #622 (NYSA_A0273-78_622)



Survey of land for Edward Harrison and others. Map #627A (NYSA_A0273-78_627A)



Survey of land for Edward Harrison and others. Map #627B (NYSA_A0273-78_627B)



Map of Northampton Patent. also the Philip Livingston Patent. Map #639 (NYSA_A0273-78_639)



Survey of land for Lendert Gansevoort and James Stewart. Map #640 (NYSA_A0273-78_640)



Map of various grants south and adjoining map #669. Map #670 (NYSA_A0273-78_670)



Part of Map No. #670 including lands of Joseph Goldthwaite and others. Map #671 (NYSA_A0273-78_671)



Map of Long Point on Lake George. Warren County. Map #672 (NYSA_A0273-78_672)



Map of lands adjoining Lake George near Fort Ticonderoga. Map #673 (NYSA_A0273-78_673)

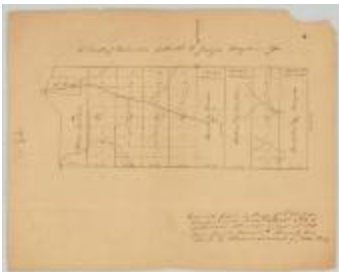

Map of first tract of Belvidere of George Croghan's Patent, Otsego county. Map #680 (NYSA_A0273-78_680)



Survey of land for Philip Livingston, Arent Stevens, Edward Collins and others. Map #692A and 692B (NYSA_A0273-78_692A_692B)

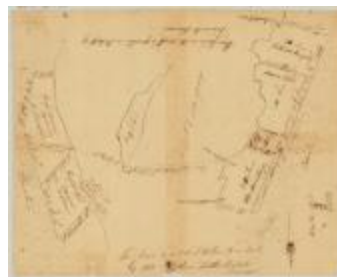

Long Island in Lake George, with adjacent uplands. Warren county. Map #693 (NYSA_A0273-78_693)



Map of Land on upper Hudson river. Map #694 (NYSA_A0273-78_694)



Survey of land for Alex Turner, 25,000 acres, on the Batten kill, and various others adjoining. Map #717 (NYSA_A0273-78_717)



Survey of land for John Lawrence, 1000 acres, north of Artillery Patent, Washington county. Map #720. (NYSA_A0273-78_720)



Map of township of Plattsburgh, 28,000 acres, on Lake Champlain. Map #721 (NYSA_A0273-78_721)



Map of Jellis Fonda, 40,000 acres, in Oneida county. Map #722 (NYSA_A0273-78_722)



Map of subdivision of Fonda's Patent, Oneida county. Map #723 (NYSA_A0273-78_723)



Delaware river, copied from a map by Metcalfe. Map #725 (NYSA_A0273-78_725)



Protraction of Isle La Motte, Lake Champlain, Vermont. Map #726 (NYSA_A0273-78_726)



Palmer's Purchase on the Sacondaga branch of Hudson river. Map #732 (NYSA_A0273-78_732)



Sketch of land in Steuben township, Oneida county; copy of Cockburn's survey. Map #735 (NYSA_A0273-78_735)



Townships of Hamden and Sidney with subdivisions. Map #736 (NYSA_A0273-78_736)

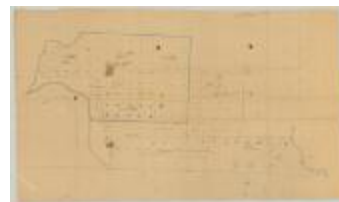

Townships of Chenango, Randolph, etc. Map #737 (NYSA_A0273-78_737)



Canadian and Nova Scotia Refugee Lands, Clinton county. Map #744A (NYSA_A0273-78_744A)



Canadian and Nova Scotia Refugee Lands, Clinton county. Map #744B (NYSA_A0273-78_744B)



Canadian and Nova Scotia Refugee Lands, Clinton county. Map #745A (NYSA_A0273-78_745A)



Canadian and Nova Scotia Refugee Lands, Clinton county. Map #745B (NYSA_A0273-78_745B)



Canadian and Nova Scotia Refugee Lands, Clinton county. Map #746 (NYSA_A0273-78_746)

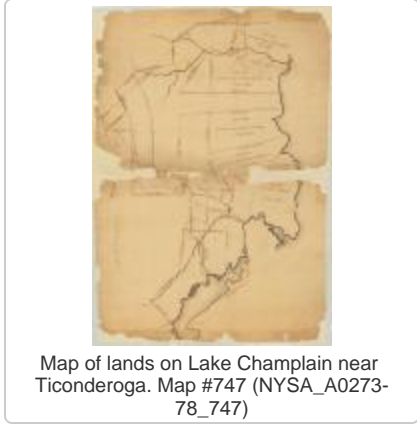

Map of lands on Lake Champlain near Ticonderoga. Map #747 (NYSA_A0273-78_747)

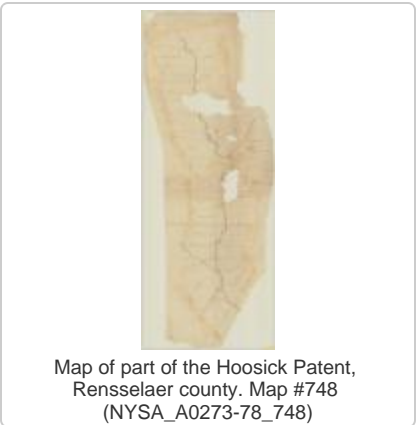

Map of part of the Hoosick Patent, Rensselaer county. Map #748 (NYSA_A0273-78_748)

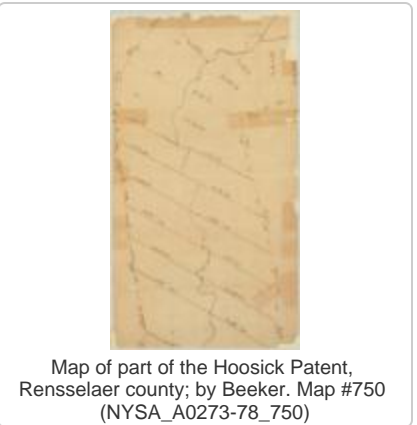

Map of part of the Hoosick Patent, Rensselaer county; by Beeker. Map #750 (NYSA_A0273-78_750)

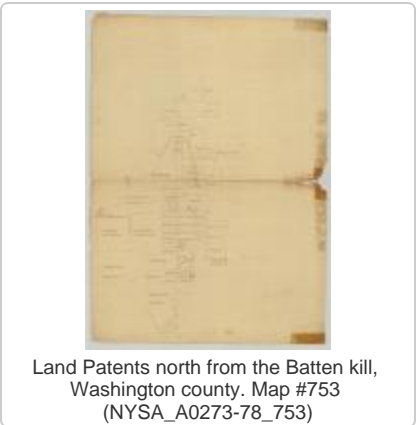

Land Patents north from the Batten kill, Washington county. Map #753 (NYSA_A0273-78_753)



Map of Willsborough and adj. lands on Lake Champlain. Map #761 (NYSA_A0273-78_761)



Township of Nettle Field; also Belvedere; Otsego county. Map #763 (NYSA_A0273-78_763)

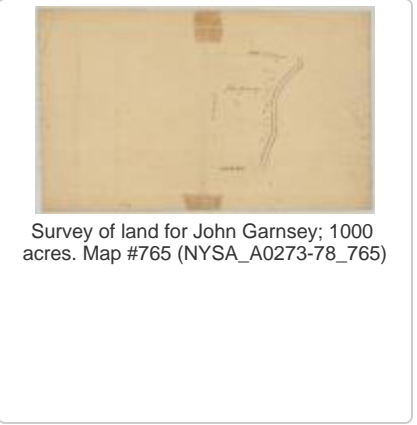

Survey of land for John Garnsey; 1000 acres. Map #765 (NYSA_A0273-78_765)

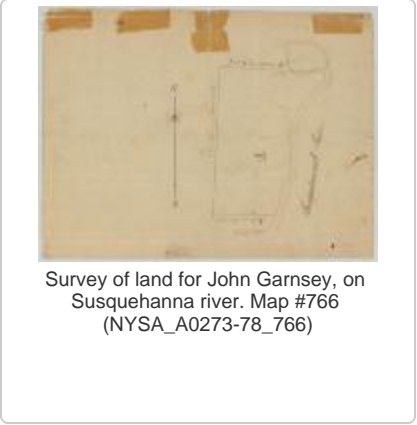

Survey of land for John Garnsey, on Susquehanna river. Map #766 (NYSA_A0273-78_766)

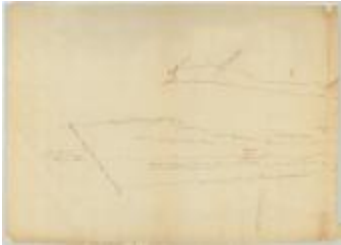

Map of Mamakating, Sullivan county, granted to Catherine Lodge et al. Map #767A (NYSA_A0273-78_767A)



Map of Mamakating, Sullivan county, granted to Catherine Lodge et al. Map #767B (NYSA_A0273-78_767B)



Map of Lake's Patent, adjoining the Wallumschack Patent. Map #770A (NYSA_A0273-78_770A)



Map of Lake's Patent adjoining Wallumschack Patent. Map #770B (NYSA_A0273-78_770B)



Locations in the Western Country. Map #772 (NYSA_A0273-78_772)



Map of Lynottville, between Goldsboro and Franklin townships. Map #773 (NYSA_A0273-78_773)



Line from outlet of Salmon river, south 60 degrees east, 35 miles; also from near Oneida lake and Wood creek. Map #776 (NYSA_A0273-78_776)



Map of road from Fort George to the river Chazy. Map #777A (NYSA_A0273-78_777A)



Map of road from Fort George to the river Chazy. Map #777B (NYSA_A0273-78_777B)



Map of road from the Oleout to the Cayuga lake. Map #778A (NYSA_A0273-78_778A)

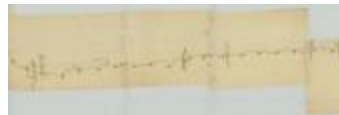

Map of road from the Oleout to the Cayuga lake. Map #778B (NYSA_A0273-78_778B)



Map of road from the Oleout to the Cayuga lake. Map #778C (NYSA_A0273-78_778C)



Map of township of Schenectady. Map #781 (NYSA_A0273-78_781)



Hasenclever's Patent on Canada creek, Herkimer county, adjoins Cosby's Manor. Map #784 (NYSA_A0273-78_784)



Map of the town of Marletown on Esopus creek. Map #786 (NYSA_A0273-78_786)



Map of second Township in Benson. Map #788 (NYSA_A0273-78_788)



Map of Canadian Refugee Lands in Clinton county and Township of Mooers on Lake Champlain. Map #789 (NYSA_A0273-78_789)



Proposed Town on Niagara river. Map #791 (NYSA_A0273-78_791)



Lands near Schroon Lake; Platt's Road Patent; Hoffman, etc. Map #793 (NYSA_A0273-78_793)



Map of Gage's Patent with Subdivisions, on Canada creek. Map #796 (NYSA_A0273-78_796)



Old Military Tract, Township 6, Clinton county and Township 7, Franklin county. Map #798 (NYSA_A0273-78_798)



Old Military Tract, Township 3, Clinton county; granted to Benj. Birdsall. Map #799 (NYSA_A0273-78_799)



Map of Lott's Patent, also of Magin's Patent. Map #803 (NYSA_A0273-78_803)



Map of land at Niagara Falls, part of Mile Strip. Map #805 (NYSA_A0273-78_805)

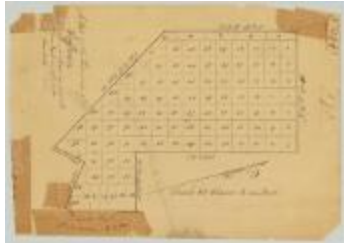

Map of Hoffman Township on Scaron lake. Essex county. Map #806 (NYSA_A0273-78_806)



Land of Ezra L'Hommedieu at the head of Seneca lake. Map #809 (NYSA_A0273-78_809)



Map of land adjacent to Scroon lake. Map #810 (NYSA_A0273-78_810)



Lands of Philip Schuyler, with others adjoining. Map #811 (NYSA_A0273-78_811)



Land between Seneca lake and Lake Ontario. Map #813 (NYSA_A0273-78_813)



Same as Map No. 813. Map #814 (NYSA_A0273-78_814)



Lands of W.J. Vredenburgh, John Lansing, Jr., and Various others adjacent to Friends Settlement. Map #815 (NYSA_A0273-78_815)



Coxe's Patent, also Hamden Tract, on Susquehanna river. Map #820 (NYSA_A0273-78_820)



Map of land given to the Canadian and Nova Scotia Refugee's. Clinton county. Map #826A (NYSA_A0273-78_826A)



Map of Canadian Refugee Lands, Clinton county. Map #826B (NYSA_A0273-78_826B)



Maps of Corporation Lands at Fort Hunter, Montgomery county. Map #828 (NYSA_A0273-78_828)



Lands and various grants at Fort Hunter, Montgomery county. Map #829 (NYSA_A0273-78_829)



Lysander, No. 1, Oswego and Onondaga counties. Map #831 (NYSA_A0273-78_831)



Hannibal, No. 2, Oswego county. Map #832 (NYSA_A0273-78_832)



Cato, No. 3, Cayuga county. Map #833 (NYSA_A0273-78_833)



Brutus, No. 4, Cayuga county. Map #834 (NYSA_A0273-78_834)



Camillus, No. 5, Onondaga county. Map #835 (NYSA_A0273-78_835)



Cicero, No. 6, Onondaga county. Map #836 (NYSA_A0273-78_836)



Manlius, No. 7, Onondaga county. Map #837 (NYSA_A0273-78_837)



Aurelius, No. 8, Cayuga county. Map #838 (NYSA_A0273-78_838)



Marcellus, No. 9, Onondaga county. Map #839 (NYSA_A0273-78_839)



Pompey, No. 10, Onondaga county. Map #840 (NYSA_A0273-78_840)



Romulus, No. 11, Seneca county. Map #841 (NYSA_A0273-78_841)



Scipio, No. 12, Cayuga county. Map #842 (NYSA_A0273-78_842)



Sempronius, No. 13, Cayuga county. Map #843 (NYSA_A0273-78_843)



Tully, No. 14, Cortland and Onondaga counties. Map #844 (NYSA_A0273-78_844)



Fabius No. 13, Cortland and Onondaga counties. Map #845 (NYSA_A0273-78_845)

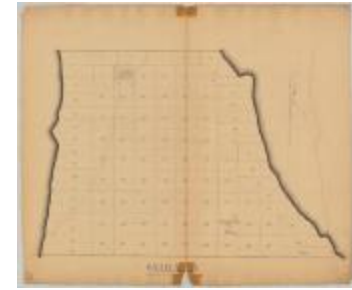

Ovid, No. 16, Seneca county. Map #846 (NYSA_A0273-78_846)



Milton, No. 17, Tompkins and Cayuga counties. Map #847 (NYSA_A0273-78_847)



Locke, No. 18, Tompkins and Cayuga counties. Map #848 (NYSA_A0273-78_848)



Homer, No. 19, Cortland county. Map #849 (NYSA_A0273-78_849)



Solon, No. 20, Cortland county. Map #850 (NYSA_A0273-78_850)



Hector, No. 21, Tompkins county. Map #851 (NYSA_A0273-78_851)



Ulysses, No. 22, Tompkins county. Map #852 (NYSA_A0273-78_852)



Dryden, No. 23, Tompkins County. Map #853 (NYSA_A0273-78_853)



Virgil, No. 24, Cortland county. Map #854 (NYSA_A0273-78_854)



Cincinnatus, No. 25, Cortland county. Map #855 (NYSA_A0273-78_855)



Junius, No. 26, Seneca county. Map #856 (NYSA_A0273-78_856)



Galen, No. 27, Wayne county. Map #857 (NYSA_A0273-78_857)



Map of Kayaderosra Patent, Saratoga county. Map #858 (NYSA_A0273-78_858)



Map of Mayfield Patent, Fulton county; 15,000 acres. Map #862 (NYSA_A0273-78_862)



Map of part of Mayfield Patent, Fulton county. Map #870 (NYSA_A0273-78_870)



Rudolph Staley's tract, 34,000 acres, also Conradt Frank's tract, 3000 acres at Burnet Field. Map #873 (NYSA_A0273-78_873)

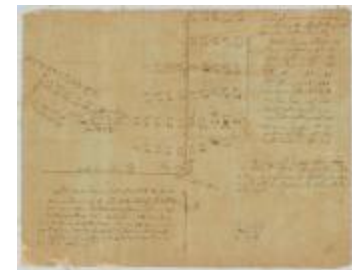

Map of lots in the village of Johnstown, Fulton county. Map #875 (NYSA_A0273-78_875)



Part of William Wood's Patent; forfeited by John Wetherhead. Map #876 (NYSA_A0273-78_876)



Map of Stone Arabia Patent, Alexander's Patent, Depeyster's and Van Slyck's patent. Map #879 (NYSA_A0273-78_879)



Map of the village of Johnstown, Fulton county. Map #880 (NYSA_A0273-78_880)



Map of Chuctinunda town on the Mohawk river; by J. V. Alen. Map #881 (NYSA_A0273-78_881)



Kayaderosera Patent, 8th, 9th and 10th allotment. Part of Saratoga Patent. Map #882 (NYSA_A0273-78_882)



Map of Wallomsack Patent and lands adjoining, Rensselaer Co. Map #883 (NYSA_A0273-78_883)



Map of Wallomsack Patent; also Snyders Patent called Mapletown. Map #884 (NYSA_A0273-78_884)



Kingsborough Patent, Lot No. 399, Fulton County. Map #885 (NYSA_A0273-78_885)



Map of Thomas Wenham's grant on Mohawk river (Oriskany patent); also land north of Cosby's Manor. Map #886A



Map of Thomas Wenham's grant on Mohawk river (Oriskany patent); also land north of Cosby's Manor. Map #886B



Kayaderosera Patent, Allotments Nos. 17 to 25, except No. 21, Saratoga county. Map #888 (NYSA_A0273-78_888)



Kingsborough Patent, Lots 7, 8, 9, and 10, Fulton Co. Map #891A (NYSA_A0273-78_891A)



Kingsborough Patent, Lots 7, 8, 9, and 10, Fulton Co. Map #891B (NYSA_A0273-78_891B)

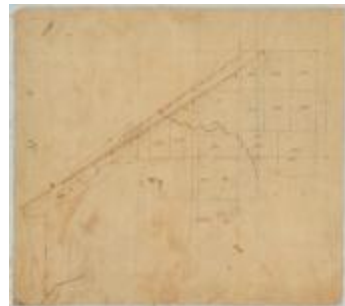

Kayaderosera Patent, Line between Lots 11 and 12. Map #892 (NYSA_A0273-78_892)

Account of the Overseers of the Poor of the Town of Orange (NYSA_A0827-78_Rockland_Orange)



Map of Lot No. 220, T[ownship] No. 10, O.M.T. [Old Military Tract] Showing Property Adjoining [and Southern Portion of Loon



Map of Township No. 12, Old Military Tract and Town of North Elba (NYSA_B1405-96_11)



Topographical map of the Salmon River, Clinton County, N.Y. (NYSA_B1405-96_18)



Central Adirondack Triangulation Network Diagram with Primary Triangulation Station Names (NYSA_B1405-96_46)



Survey of Hudson River, Sheet 1 (NYSA_B1405-96_62)



Map of Ticonderoga (NYSA_B1405-96_157)



Map of Crown Point (NYSA_B1405-96_170)



Map of Township No. 8, John Brown's Tract (NYSA_B1405-96_179)



Map of Lake George (NYSA_B1405-96_180)



Map of French and English Grants on Lake Champlain (NYSA_B1405-96_202)



Ground Plan of Beds and Veins of Magnetic Oxide of Iron: Traversing the Hypersthene and Feldspathic Rocks at Adirondack Essex County, New York (NYSA_B1405-96_310)



A Map exhibiting the relative position of the Veins of Iron Ore in and adjoining the Village of McIntyre, Essex County, New



Lake Placid (NYSA_B1405-96_346)



New Map of Northern New York Including the Adirondack Region (NYSA_B1405-96_413)



Map of the New York Wilderness [showing triangulations of the Adirondack Mountains] (NYSA_B1405-96_454)

New York (State).
Court of Chancery.

J0071

Index to miscellaneous files in
Chancery, 1772-1847

Photo by Scott S. Hill, Jr., NY State Library
NY State Library, Albany, NY

Index to miscellaneous files in Chancery, 1772-1847 (NYSA_J0071-82_Index)

New York (State).
Court of Chancery.

J1071

Index to Chancery papers, 1808-1847

These cards (1808-1847) were made by the State Library, Albany, NY, from the original papers in the Court of Chancery, Albany, NY. They are arranged in alphabetical order of the complainant's name. The numbers on the cards refer to the original papers in the Court of Chancery, Albany, NY.

Index to Chancery Papers by complainant (NYSA_J1071-82_Index)



A Map of Lands applied for by Sundry persons by virtues of Improvements and occupancies there of prior to the 22 July 1782 situate in the County of Ulster in the Town of Mamakating (NYSL_SC17820_B3_F15)

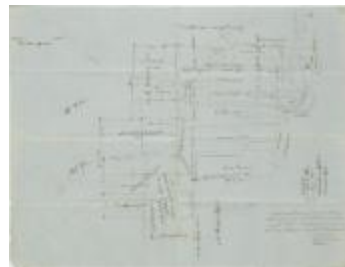

A Map showing the division of part of the real Estate of Col. C. Schoonmaker dec'd in the Town of Mamakating (NYSL_SC17820_B3_F17)



A Map of Lot No. 54 of the Little Nine Partners and the Gore of Lands adjacent belonging to George Clark Perry [?] (NYSL_SC17820_B4_F7)



Map of Patents on the Shawangunk Kill (NYSL_SC17820_B4_F12)



Map of Warren Township (NYSL_SC17820_B14_F15)