



Map of a Part of Indian River (NYSA\_B1405-96\_03)



Map of Bad Luck Ponds (NYSA\_B1405-96\_04)



A Map of the West Part of Township No. 1 of the Old Military Tract (NYSA\_B1405-96\_096A)



Map of Lot No. 220, T[ownship] No. 10, O.M.T. [Old Military Tract] Showing Property Adjoining [and Southern Portion of Loon



Map Showing the Western Boundary Line of Totten and Crossfield's Purchase (NYSA\_B1405-96\_2B01)



Map of the Border between Totten and Crossfield's Purchase, and Macomb's Purchase (NYSA\_B1405-96\_2B02)



Map of the Border between Totten and Crossfield's Purchase, and Macomb's Purchase, including Burnt Lake and Salmon



Map of the North West Corner of Totten and Crossfield (NYSA\_B1405-96\_5B)



Map of the Adirondack Wilderness (NYSA\_B1405-96\_6)



Map of Brown's Tract (NYSA\_B1405-96\_6B)



Colton's Map of the New York Wilderness and the Adirondacks (NYSA\_B1405-96\_7)



Map of Forest Port (NYSA\_B1405-96\_7A)



Map of Township No. 12, Old Military Tract and Town of North Elba (NYSA\_B1405-96\_11)

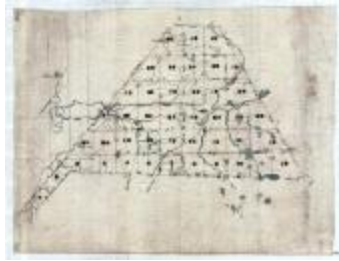

Map of Long Pond (NYSA\_B1405-96\_11B)



Map of Big Moose Lake and the Adjacent Lakes, Ponds, Streams and Trails (NYSA\_B1405-96\_14)



Topographical map of the Salmon River, Clinton County, N.Y. (NYSA\_B1405-96\_18)



Plan of the Carthage and Champlain Road from Beach's Lake to Raquette Lake (NYSA\_B1405-96\_21B)



Map of Bell Hill and Various Hills and Mountains in the Adirondacks (NYSA\_B1405-96\_30B)



Map of Township No. 31, Totten and Crossfield's Purchase (NYSA\_B1405-96\_40)



Map of State Lands in Great Lots 4 & 5 of Palmers Purchase, Rear Division (NYSA\_B1405-96\_42)



Map Showing the Division Lines Between the Arthurborough, Nobleborough and Vrooman Patents (NYSA\_B1405-96\_43A)



Central Adirondack Triangulation Network Diagram with Primary Triangulation Station Names (NYSA\_B1405-96\_46)



Survey of Hudson River, Sheet 1 (NYSA\_B1405-96\_62)



Map of Timber Lands near Totten and Crossfield's Purchase and Brown's Tract (NYSA\_B1405-96\_71A)



Map of Timber Lands between Totten and Crossfield's Purchase and Brown's Tract (NYSA\_B1405-96\_71B)



Map of Timber Lands around the Oswegatchie River (NYSA\_B1405-96\_71C)



Map of Timber Lands on Totten and Crossfield Purchase and Brown's Tract (NYSA\_B1405-96\_71D)



Map of Timber Lands around Watson's Corner (NYSA\_B1405-96\_71E)



Map of Timber Lands around the Township of Burnt Hill (NYSA\_B1405-96\_71F)



Map of Timber Lands in part of St. Lawrence County (NYSA\_B1405-96\_71G)



Map of the Adirondack Game Preserve, owned by the J&J Rogers Co., AuSable Forks (NYSA\_B1405-96\_75)

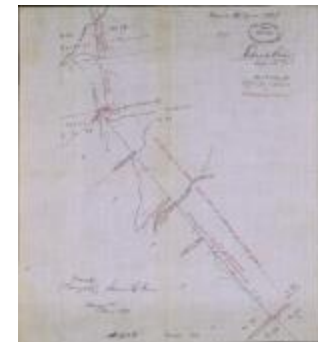

Totten & Crossfield's Purchase, Line Between Township No. 47 and No. 50 (NYSA\_B1405-96\_78)



Map of Lake Placid (NYSA\_B1405-96\_90A)



Map of Township No. 9 of the Old Military Tract in the County of Franklin (NYSA\_B1405-96\_98A)



Map Exhibiting the Relative Position of the Veins of Iron Ore in and Adjoining the Village of McIntyre (NYSA\_B1405-96\_102A)

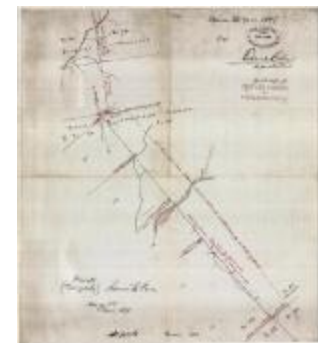

Totten & Crossfield Purchase and Macomb's Purchase (NYSA\_B1405-96\_103A)





Map of Watson, Chassinus, and Brown's Tract (NYSA\_B1405-96\_104A1)



Map of Independence River and Chase Lake (NYSA\_B1405-96\_104A2)



Map of Black Creek (NYSA\_B1405-96\_104A4.tif)



Map of Lot No. 31 Rogers Patent in Town of North Hudson (NYSA\_B1405-96\_105A.tif)



Map showing marshland, trees, and elevation, with numbered points 40-63 along an unnamed river (NYSA\_B1405-96\_107A1)



Map showing marshland and trees, with numbered points along an unnamed river, and the trail to Burnham (NYSA\_B1405-96\_107A2.tif)



Map of Oak and Pine Mountain near the confluence of the Lake Pleasant and North branches of the Sacandaga River (NYSA\_B1405-96\_107A3)



Map of Township 9 and 10 Totten & Crossfield Purchase, Hamilton County, NY (NYSA\_B1405-96\_107A4)



Map of Township Number 10 (NYSA\_B1405-96\_107A5)

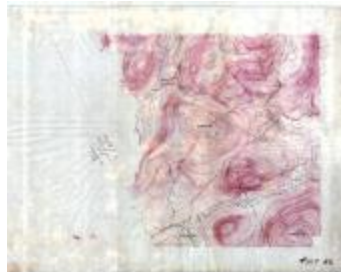

Map of Dunning Mountain (NYSA\_B1405-96\_107A6)



Map of Townships 9 and 10 in the Totten and Crossfield Purchase (Marked #2 of Series) (NYSA\_B1405-96\_107B1)



Map of Township Number 10 (Marked #3 of Series) (NYSA\_B1405-96\_107B2)



Map of Township Number 10 (Marked #4 of Series) (NYSA\_B1405-96\_107B3)



Map of Township Number 8 and Moose River Tract (NYSA\_B1405-96\_109A)



Map of Connery Pond (NYSA\_B1405-96\_118A)



Map of Eastern Coast of Lake Placid (NYSA\_B1405-96\_118A01)



Map of a portion of the East shore of Lake Placid, north east from Pulpit Rock to a point south east from Hawk Island



Map of a Portion of the North East Shore of Lake Placid (NYSA\_B1405-96\_118A03)



Map of a portion of the shore line of Lake Placid and Paradox Bay (NYSA\_B1405-96\_118A04A)



Map of a Portion of Lake Placid showing Pollywog Bay, Index Point, and Sunset Strait (NYSA\_B1405-96\_118A04attachment)



Map of a Portion of the Shore Line of Lake Placid, showing Gull Rock and Moose Island (NYSA\_B1405-96\_118A05)



Map of a Portion of the N. W. Shore of Lake Placid, showing North Elba townline (NYSA\_B1405-96\_118A06)



Map of the Shore Line of Lake Placid, showing Echo Bay (NYSA\_B1405-96\_118A07)



Map of Moose Island (NYSA\_B1405-96\_118A08)





Map of Moose Island, Located in Lake Placid (NYSA\_B1405-96\_118A09)

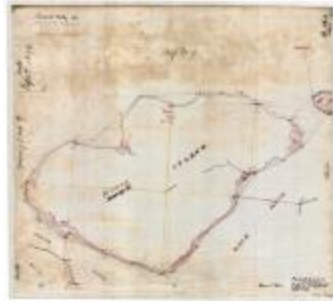

Map of the East Shore and outlet of Mirror Lake (NYSA\_B1405-96\_118A10)



Map of Part of the Outlet of Lake Placid Showing False Outlet (NYSA\_B1405-96\_118A11)



Map of a Part of Elba River with the Inlet of the Lake Placid Outlet and Adjacent Highways (NYSA\_B1405-96\_118A12)

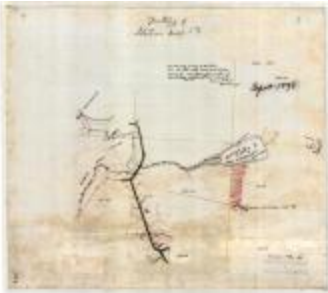

Map Showing Survey of Mud Pond and its Outlet (NYSA\_B1405-96\_118A13)



Map Showing a Survey of the Highway from Chellis Place (NYSA\_B1405-96\_118A14)



Map of a Portion of the West Branch of the Ausable River (NYSA\_B1405-96\_118A15)



Map of the Western Branch of the Ausable River (NYSA\_B1405-96\_118AE)



Map of the West Branch of the Ausable River (NYSA\_B1405-96\_118AF)



Map of the New York Wilderness (NYSA\_B1405-96\_119A)



Map of the New York Wilderness (Damaged) (NYSA\_B1405-96\_119B)



Totten & Crossfield's Purchase, (Line Between Township No. 47 and No. 50) (NYSA\_B1405-96\_122)



Progress Sketch of the Primary Triangulation (NYSA\_B1405-96\_125)



Map of Nobleborough and Arthurborough (NYSA\_B1405-96\_126)



Map of Mountains in Saratoga County (NYSA\_B1405-96\_142A)



Reconnaissance Sketch Showing the "Beaver Dam Fly" in Township No. 35, Totten and Crossfield's Purchase.



Map Showing the Location of Edmond's Ponds, Now Cascade Lakes (NYSA\_B1405-96\_148)



Map of Land Ceded by the St. Regis Indians to the State of New York in the Year 1825 containing 888.66 acres (NYSA\_B1405-96\_150A)



Map of Land Ceded by the St. Regis Indians to the State of New York in the year 1824 containing 1023.34 acres (NYSA\_B1405-96\_150A01)



Document describing the Ceding of Lands by the St. Regis Indians (NYSA\_B1405-96\_150A01attachment)



Map of North Eastern New York near Lake Champlain (NYSA\_B1405-96\_150A02)

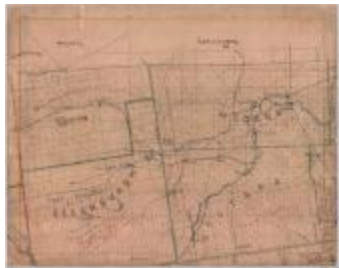

Map of the Towns of Clinton, Altona, Ellensburg and Moders, Located in Clinton County (NYSA\_B1405-96\_150A03)



Map of the Towns of Plattsburgh, Beekmantown, Schuyler Falls, Peru and Au Sable (NYSA\_B1405-96\_150A04)



Map of the Towns of Plattsburgh, Beekmantown, Schuyler Falls, Peru and Au Sable, Ellenburg, Belmont, Franklin, Black Brook, Saranac and Dannemora (NYSA\_B1405-96\_150A05)



Map of the Towns of Chesterfield, Lewis, Wilsborough and Essex (NYSA\_B1405-96\_150A06)



Map of the Towns of Au Sable, Franklin, Black Brook, Chesterfield, Lewis, Jay, Wilmington, Keene, North Elba, and St. Armand (NYSA\_B1405-96\_150A07)



Map of State Lands in Great Lots No.4 & No.5 of Palmers Purchase, Rear Division (NYSA\_B1405-96\_155)



Map of Ticonderoga (NYSA\_B1405-96\_157)



Map of Crown Point (NYSA\_B1405-96\_170)



Progress Sketch of the Primary Triangulation (NYSA\_B1405-96\_174)



Map of Saranac River, from Union falls to Clayburg showing part of the Town of Black Brook (NYSA\_B1405-96\_175D)



Map of Township No. 8, John Brown's Tract (NYSA\_B1405-96\_179)



Map of Lake George (NYSA\_B1405-96\_180)



Map of French and English Grants on Lake Champlain (NYSA\_B1405-96\_202)



Map Showing Ice Measurements of Limekiln Lake (NYSA\_B1405-96\_207)



Map of Bayard's or Freemason's Patent (NYSA\_B1405-96\_223)



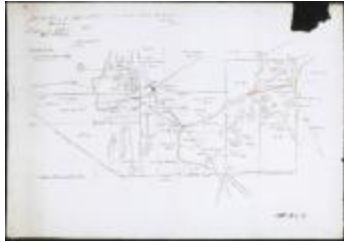

Map of Lands as Divided September 1889  
(NYSA\_B1405-96\_239)

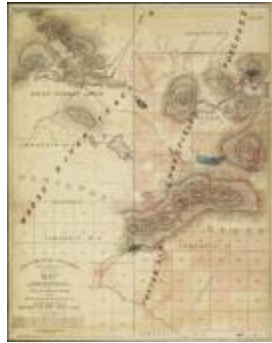

Map Showing the Location of the NW  
Corner of Township No. 3, in Totten and  
Crossfield's Purchase on the Boundary of



Map of the Inlet of Lake Champlain and Part  
of Lake George (NYSA\_B1405-96\_252)



Sketch Showing the Proposed Boundary of  
the State Forest Reservation in the  
Adirondack Region, In Accordance with the



Map of the Beaver River Between Beaver  
and Albany Lakes (NYSA\_B1405-96\_275)



Progress Sketch Upper Saranac Lake  
(NYSA\_B1405-96\_305)



Ground Plan of Beds and Veins of Magnetic  
Oxide of Iron: Traversing the Hypersthene  
and Feldspathic Rocks at Adirondack Essex  
County, New York (NYSA\_B1405-96\_310)



A Map exhibiting the relative position of the  
Veins of Iron Ore in and adjoining the  
Village of McIntyre, Essex County, New



Lake Placid (NYSA\_B1405-96\_346)



Map Showing the True Boundaries of Lands  
at Ampersand and Saranac (NYSA\_B1405-  
96\_366)

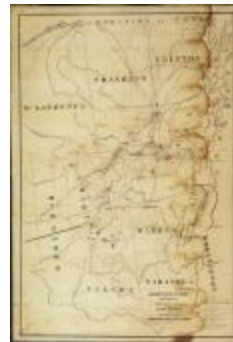

Sketch Showing the Progress of the Primary  
Triangulation (NYSA\_B1405-96\_367)



Map of the Survey of the Sacondaga [sic]  
River Between Station 484 and Station 551  
(NYSA\_B1405-96\_395)



New Map of Northern New York Including the Adirondack Region (NYSA\_B1405-96\_413)



Map of a Part of Hyde Township (NYSA\_B1405-96\_423)



Map of Northern New York Including the Adirondack Region (NYSA\_B1405-96\_424)



Map of the New York Wilderness [showing triangulations of the Adirondack Mountains] (NYSA\_B1405-96\_454)



Map Showing the Closure of the Lines Run by Transit for the Determination of the Southeasterly Corner of the County of Franklin in the Line of Essex at the Preston Road (NYSA\_B1405-96\_462)



Map of the Adirondack Forest and Adjoining Territory (NYSA\_B1405-96\_512)