



Map of Township Cato (No. 3). Map #103  
(NYSA\_A0273-78\_103)



Map of Great Hardenbergh Patent. Map  
#140 (NYSA\_A0273-78\_140)



Map of part of the Village of Lewiston. Map  
#347 (NYSA\_A0273-78\_347)



Map of the Town of White Plains,  
Westchester County. Map #404D (Copy)  
(NYSA\_A0273-78\_404D)



Map of Onondaga Salt Lake. Map #410  
(NYSA\_A0273-78\_410)



Map of the Town of Kinderhook. Map #411  
(NYSA\_A0273-78\_411)



Map of the Town of Coxsackie, Green  
County. Map #420 (NYSA\_A0273-78\_420)



Map of the Township of West Chester. Map  
#424 (NYSA\_A0273-78\_424)



Map of Black Rock Village. Erie County.  
Map #425 (NYSA\_A0273-78\_425)



Map of Fort Richmond, Staten Island. Map  
#427 (NYSA\_A0273-78\_427)



Map of lands adjoining Lake Champlain in  
Clinton and Essex Counties. Map #428  
(NYSA\_A0273-78\_428)



Map of Phillipstown, Dutchess County. Map  
#430 (NYSA\_A0273-78\_430)



Map of the Town of Shawangunk, Ulster County. Map #433 (NYSA\_A0273-78\_433)



Plan for subdividing the State Lands south of Erie Canal and east of West Street. Map #453 (NYSA\_A0273-78\_453)



Map of Subdivisions of lands near Church Street, Syracuse. Map #458B (NYSA\_A0273-78\_458B)



Map of several pieces of land situated in the Town of Bushwick, Kings County. Map #464 (NYSA\_A0273-78\_464)



Map of Oriskany Patent, Oneida County. Map #465 (NYSA\_A0273-78\_465)



Map of Tompkins County. Map #471 (NYSA\_A0273-78\_471)



Profile of the Wallkill river at Walden, Orange County. Map #472A (NYSA\_A0273-78\_472A)



Profile of the Wallkill river at Walden, Orange County. Map #472B (NYSA\_A0273-78\_472B)



Document with Profile of the Wallkill river at Walden, Orange County. Map #472C (NYSA\_A0273-78\_472C)



Lake George from original plot. Map #476A (NYSA\_A0273-78\_476A)



Lake George from original plot. Map #476B (NYSA\_A0273-78\_476B)



Map of Coarse Salt Lands at Syracuse, N. Y. Map #494 (NYSA\_A0273-78\_494)



Bluff Point, in Raquette Lake, Hamilton County. Map #500 (NYSA\_A0273-78\_500)



Map of Lake George. 1880. Map #502 (NYSA\_A0273-78\_502)



Totten and Crossfield's Purchase, Township 40 showing Raquette Lake. Map #503 (NYSA\_A0273-78\_503)



Totten and Crossfield's Purchase, Township 40 showing Raquette Lake. Map #503A (NYSA\_A0273-78\_503A)



Boundary line between the Towns of Exeter and Burlington. Map #507 (NYSA\_A0273-78\_507)



Map of Hoyt's Salt Block, 1st Ward, Syracuse. Map #508 (NYSA\_A0273-78\_508)



Corner Location of Benson Township, Jerseyfield Patent and Lawrence Patent. Map #512 (NYSA\_A0273-78\_512)



Macomb's Purchase. Great Lot No. 1, Township 20, Franklin County. Map #513 (NYSA\_A0273-78\_513)



Map of State Land in Buffalo, New York. Map #515 (NYSA\_A0273-78\_515)



Sempronius, Lot No. 61. Cayuga County. Map #521 (NYSA\_A0273-78\_521)



Hudson and Mohawk river Confluence and Haver or Peebles island at mouth of Mohawk. Map #529A (NYSA\_A0273-78\_529A)



Mohawk river Confluence and Haver or Peebles island at mouth of Mohawk. Map #529B (NYSA\_A0273-78\_529B)

Oversized  
item

Map of Township of Lake Pleasant,  
Hamilton County. Map #587 (NYSA\_A0273-  
78\_587)

Item not  
available

Map of State Lands, (Ne-ha-sa-ne park)  
Hamilton and Herkimer Co. Map #588  
(NYSA\_A0273-78\_588)



Survey of Land for Pietrus Van Dreissen  
and John Van Dreissen. Map #622  
(NYSA\_A0273-78\_622)



Survey of land for Edward Harrison and  
others. Map #627A (NYSA\_A0273-78\_627A)



Survey of land for Edward Harrison and  
others. Map #627B (NYSA\_A0273-78\_627B)



Map of Northhampton Patent. also the Philip  
Livingston Patent. Map #639 (NYSA\_A0273-  
78\_639)



Survey of land for Lendert Gansevoort and  
James Stewart. Map #640 (NYSA\_A0273-  
78\_640)



Map of various grants south and adjoining  
map #669. Map #670 (NYSA\_A0273-  
78\_670)



Part of Map No. #670 including lands of  
Joseph Goldthwaite and others. Map #671  
(NYSA\_A0273-78\_671)



Map of Long Point on Lake George. Warren  
County. Map #672 (NYSA\_A0273-78\_672)



Map of lands adjoining Lake George near  
Fort Ticonderoga. Map #673 (NYSA\_A0273-  
78\_673)

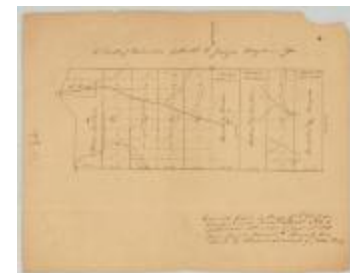

Map of first tract of Belvidere of George  
Croghan's Patent, Otsego county. Map #680  
(NYSA\_A0273-78\_680)



Survey of land for Philip Livingston, Arent Stevens, Edward Collins and others. Map #692A and 692B (NYSA\_A0273-78\_692A\_692B)



Long Island in Lake George, with adjacent uplands. Warren county. Map #693 (NYSA\_A0273-78\_693)



Map of Land on upper Hudson river. Map #694 (NYSA\_A0273-78\_694)



Survey of land for Alex Turner, 25,000 acres, on the Batten kill, and various others adjoining. Map #717 (NYSA\_A0273-78\_717)



Survey of land for John Lawrence, 1000 acres, north of Artillery Patent, Washington county. Map #720. (NYSA\_A0273-78\_720)



Map of township of Plattsburgh, 28,000 acres, on Lake Champlain. Map #721 (NYSA\_A0273-78\_721)



Map of Jellis Fonda, 40,000 acres, in Oneida county. Map #722 (NYSA\_A0273-78\_722)



Map of subdivision of Fonda's Patent, Oneida county. Map #723 (NYSA\_A0273-78\_723)



Delaware river, copied from a map by Metcalfe. Map #725 (NYSA\_A0273-78\_725)



Protraction of Isle La Motte, Lake Champlain, Vermont. Map #726 (NYSA\_A0273-78\_726)



Palmer's Purchase on the Sacondaga branch of Hudson river. Map #732 (NYSA\_A0273-78\_732)



Sketch of land in Steuben township, Oneida county; copy of Cockburn's survey. Map #735 (NYSA\_A0273-78\_735)



Townships of Hamden and Sidney with subdivisions. Map #736 (NYS A0273-78\_736)

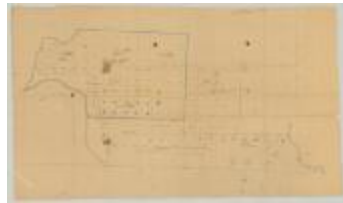

Townships of Chenango, Randolph, etc. Map #737 (NYS A0273-78\_737)



Canadian and Nova Scotia Refugee Lands, Clinton county. Map #744A (NYS A0273-78\_744A)



Canadian and Nova Scotia Refugee Lands, Clinton county. Map #744B (NYS A0273-78\_744B)



Canadian and Nova Scotia Refugee Lands, Clinton county. Map #745A (NYS A0273-78\_745A)



Canadian and Nova Scotia Refugee Lands, Clinton county. Map #745B (NYS A0273-78\_745B)

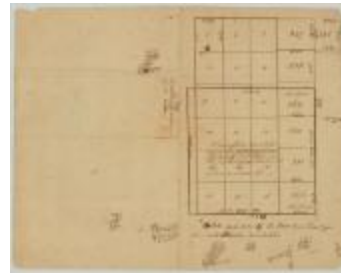

Canadian and Nova Scotia Refugee Lands, Clinton county. Map #746 (NYS A0273-78\_746)



Map of lands on Lake Champlain near Ticonderoga. Map #747 (NYS A0273-78\_747)



Map of part of the Hoosick Patent, Rensselaer county. Map #748 (NYS A0273-78\_748)



Map of part of the Hoosick Patent, Rensselaer county; by Beeker. Map #750 (NYS A0273-78\_750)



Land Patents north from the Batten kill, Washington county. Map #753 (NYS A0273-78\_753)



Map of Willsborough and adj. lands on Lake Champlain. Map #761 (NYS A0273-78\_761)

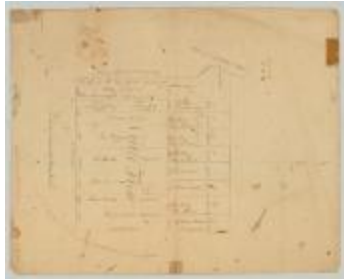

Township of Nettle Field; also Belvedere; Otsego county. Map #763 (NYS A0273-78\_763)



Survey of land for John Garnsey; 1000 acres. Map #765 (NYS A0273-78\_765)

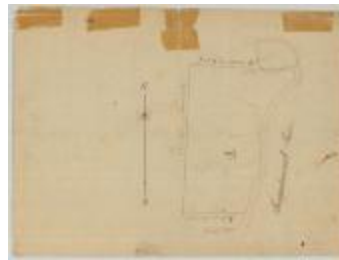

Survey of land for John Garnsey, on Susquehanna river. Map #766 (NYS A0273-78\_766)



Map of Mamakating, Sullivan county, granted to Catherine Lodge et al. Map #767A (NYS A0273-78\_767A)



Map of Mamakating, Sullivan county, granted to Catherine Lodge et al. Map #767B (NYS A0273-78\_767B)



Map of Lake's Patent, adjoining the Wallumschack Patent. Map #770A (NYS A0273-78\_770A)



Map of Lake's Patent adjoining Wallumschack Patent. Map #770B (NYS A0273-78\_770B)



Locations in the Western Country. Map #772 (NYS A0273-78\_772)

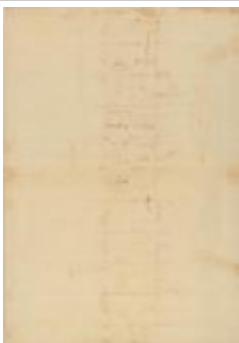

Map of Lynottville, between Goldsboro and Franklin townships. Map #773 (NYS A0273-78\_773)



Line from outlet of Salmon river, south 60 degrees east, 35 miles; also from near Oneida lake and Wood creek. Map #776 (NYS A0273-78\_776)



Map of road from Fort George to the river Chazy. Map #777A (NYS A0273-78\_777A)



Map of road from Fort George to the river Chazy. Map #777B (NYS A0273-78\_777B)



Map of road from the Oleout to the Cayuga lake. Map #778A (NYS A0273-78\_778A)

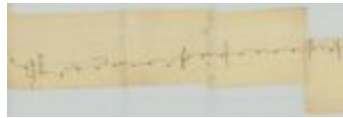

Map of road from the Oleout to the Cayuga lake. Map #778B (NYS A0273-78\_778B)



Map of road from the Oleout to the Cayuga lake. Map #778C (NYS A0273-78\_778C)



Map of township of Schenectady. Map #781 (NYS A0273-78\_781)



Hasenclever's Patent on Canada creek, Herkimer county, adjoins Cosby's Manor. Map #784 (NYS A0273-78\_784)



Map of the town of Marretown on Esopus creek. Map #786 (NYS A0273-78\_786)



Map of second Township in Benson. Map #788 (NYS A0273-78\_788)



Map of Canadian Refugee Lands in Clinton county and Township of Mooers on Lake Champlain. Map #789 (NYS A0273-78\_789)



Proposed Town on Niagara river. Map #791 (NYS A0273-78\_791)



Lands near Schroon Lake; Platt's Road Patent; Hoffman, etc. Map #793 (NYS A0273-78\_793)



Map of Gage's Patent with Subdivisions, on Canada creek. Map #796 (NYS A0273-78\_796)



Old Military Tract, Township 6, Clinton county and Township 7, Franklin county. Map #798 (NYS A0273-78\_798)





Old Military Tract, Township 3, Clinton county; granted to Benj. Birdsall. Map #799 (NYS A0273-78\_799)



Map of Lott's Patent, also of Magin's Patent. Map #803 (NYS A0273-78\_803)



Map of land at Niagara Falls, part of Mile Strip. Map #805 (NYS A0273-78\_805)



Map of Hoffman Township on Scaron lake. Essex county. Map #806 (NYS A0273-78\_806)



Land of Ezra L'Hommedieu at the head of Seneca lake. Map #809 (NYS A0273-78\_809)



Map of land adjacent to Scroon lake. Map #810 (NYS A0273-78\_810)



Lands of Philip Schuyler, with others adjoining. Map #811 (NYS A0273-78\_811)



Land between Seneca lake and Lake Ontario. Map #813 (NYS A0273-78\_813)



Same as Map No. 813. Map #814 (NYS A0273-78\_814)



Lands of W.J. Vredenburg, John Lansing, Jr., and Various others adjacent to Friends Settlement. Map #815 (NYS A0273-78\_815)



Coxe's Patent, also Hamden Tract, on Susquehanna river. Map #820 (NYS A0273-78\_820)



Map of land given to the Canadian and Nova Scotia Refugee's. Clinton county. Map #826A (NYS A0273-78\_826A)



Map of Canadian Refugee Lands, Clinton county. Map #826B (NYSA\_A0273-78\_826B)



Maps of Corporation Lands at Fort Hunter, Montgomery county. Map #828 (NYSA\_A0273-78\_828)



Lands and various grants at Fort Hunter, Montgomery county. Map #829 (NYSA\_A0273-78\_829)



Lysander, No. 1, Oswego and Onondaga counties. Map #831 (NYSA\_A0273-78\_831)



Hannibal, No. 2, Oswego county. Map #832 (NYSA\_A0273-78\_832)



Cato, No. 3, Cayuga county. Map #833 (NYSA\_A0273-78\_833)



Brutus, No. 4, Cayuga county. Map #834 (NYSA\_A0273-78\_834)



Camillus, No. 5, Onondaga county. Map #835 (NYSA\_A0273-78\_835)



Cicero, No. 6, Onondaga county. Map #836 (NYSA\_A0273-78\_836)



Manlius, No. 7, Onondaga county. Map #837 (NYSA\_A0273-78\_837)



Aurelius, No. 8, Cayuga county. Map #838 (NYSA\_A0273-78\_838)



Marcellus, No. 9, Onondaga county. Map #839 (NYSA\_A0273-78\_839)



Pompey, No. 10, Onondaga county. Map #840 (NYSA\_A0273-78\_840)



Romulus, No. 11, Seneca county. Map #841 (NYSA\_A0273-78\_841)



Scipio, No. 12, Cayuga county. Map #842 (NYSA\_A0273-78\_842)



Sempronius, No. 13, Cayuga county. Map #843 (NYSA\_A0273-78\_843)



Tully, No. 14, Cortland and Onondaga counties. Map #844 (NYSA\_A0273-78\_844)



Fabius No. 13, Cortland and Onondaga counties. Map #845 (NYSA\_A0273-78\_845)

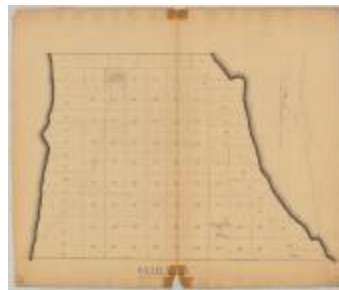

Ovid, No. 16, Seneca county. Map #846 (NYSA\_A0273-78\_846)



Milton, No. 17, Tompkins and Cayuga counties. Map #847 (NYSA\_A0273-78\_847)



Locke, No. 18, Tompkins and Cayuga counties. Map #848 (NYSA\_A0273-78\_848)



Homer, No. 19, Cortland county. Map #849 (NYSA\_A0273-78\_849)



Solon, No. 20, Cortland county. Map #850 (NYSA\_A0273-78\_850)



Hector, No. 21, Tompkins county. Map #851 (NYSA\_A0273-78\_851)



Ulysses, No. 22, Tompkins county. Map #852 (NYSA\_A0273-78\_852)



Dryden, No. 23, Tompkins County. Map #853 (NYSA\_A0273-78\_853)



Virgil, No. 24, Cortland county. Map #854 (NYSA\_A0273-78\_854)

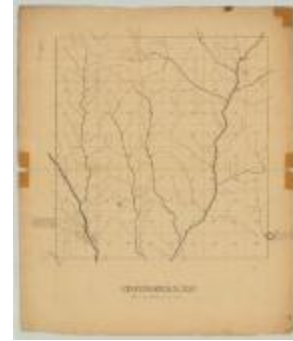

Cincinnatus, No. 25, Cortland county. Map #855 (NYSA\_A0273-78\_855)



Junius, No. 26, Seneca county. Map #856 (NYSA\_A0273-78\_856)



Galen, No. 27, Wayne county. Map #857 (NYSA\_A0273-78\_857)



Map of Kayaderosra Patent, Saratoga county. Map #858 (NYSA\_A0273-78\_858)



Map of Mayfield Patent, Fulton county; 15,000 acres. Map #862 (NYSA\_A0273-78\_862)

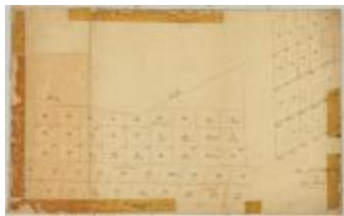

Map of part of Mayfield Patent, Fulton county. Map #870 (NYSA\_A0273-78\_870)



Rudolph Staley's tract, 34,000 acres, also Conradt Frank's tract, 3000 acres at Burnet Field. Map #873 (NYSA\_A0273-78\_873)



Map of lots in the village of Johnstown, Fulton county. Map #875 (NYSA\_A0273-78\_875)



Part of William Wood's Patent; forfeited by John Wetherhead. Map #876 (NYSA\_A0273-78\_876)



Map of Stone Arabia Patent, Alexander's Patent, Depeyster's and Van Slyck's patent. Map #879 (NYS A0273-78\_879)



Map of the village of Johnstown, Fulton county. Map #880 (NYS A0273-78\_880)

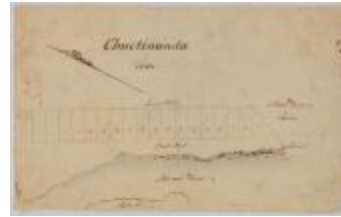

Map of Chuctinunda town on the Mohawk river; by J. V. Alen. Map #881 (NYS A0273-78\_881)



Kayaderosera Patent, 8th, 9th and 10th allotment. Part of Saratoga Patent. Map #882 (NYS A0273-78\_882)



Map of Wallomsack Patent and lands adjoining, Rensselaer Co. Map #883 (NYS A0273-78\_883)



Map of Wallomsack Patent; also Snyders Patent called Mapletown. Map #884 (NYS A0273-78\_884)



Kingsborough Patent, Lot No. 399, Fulton County. Map #885 (NYS A0273-78\_885)



Map of Thomas Wenham's grant on Mohawk river (Oriskany patent); also land north of Cosby's Manor. Map #886A



Map of Thomas Wenham's grant on Mohawk river (Oriskany patent); also land north of Cosby's Manor. Map #886B



Kayaderosera Patent, Allotments Nos. 17 to 25, except No. 21, Saratoga county. Map #888 (NYS A0273-78\_888)



Kingsborough Patent, Lots 7, 8, 9, and 10, Fulton Co. Map #891A (NYS A0273-78\_891A)



Kingsborough Patent, Lots 7, 8, 9, and 10, Fulton Co. Map #891B (NYS A0273-78\_891B)

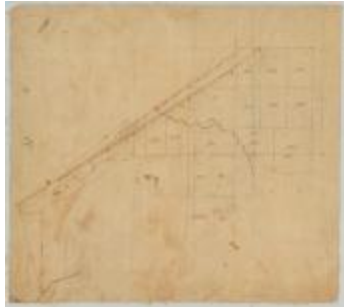

Kayaderosera Patent, Line between Lots 11 and 12. Map #892 (NYSA\_A0273-78\_892)



Niagara Falls. Old Terrapin Tower and Horseshoe Falls. (NYSA\_A3045-78\_A10401)



Sing Sing admission register (NYSA\_B0143-98)



Plan of Gates for Lower Lock, Upper Side Cut, West Troy (NYSA\_B0292-85\_V004\_84)



Map of the Enlargement of the Erie Canal. Section 50 (NYSA\_B0292-85\_V054\_50)

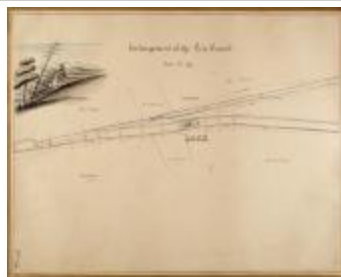

Map of the Enlargement of the Erie Canal. Section 51 (NYSA\_B0292-85\_V054\_52)



Lock Irons. Lockport Irons. No. 3 (NYSA\_B0379-85\_V17\_1)



Plan of the Locks at Lockport (NYSA\_B0379-85\_V17\_2)



General Plan for Pier at the Head of Double Locks. Erie Canal. (NYSA\_B0380-85\_0657)



Survey of lands under water for Caleb S. Woodhull et al (NYSA\_B2321-11\_18470107\_Woodhull\_etal\_01)



Survey of lands under water for Caleb S. Woodhull et al (NYSA\_B2321-11\_18470107\_Woodhull\_etal\_02)



Survey of lands under water for Caleb S. Woodhull et al (NYSA\_B2321-11\_18470107\_Woodhull\_etal\_03)



Survey of lands under water for Caleb S. Woodhull et al (NYSA\_B2321-11\_18470107\_Woodhull\_etal\_04)



Survey of lands under water for Caleb S. Woodhull et al (NYSA\_B2321-11\_18470107\_Woodhull\_etal\_05)



Survey of lands under water for William Bolmer (NYSA\_B2321-11\_18470224\_Bolmer)



Survey of lands under water for Elnathan Hawkins (NYSA\_B2321-11\_18470901\_Hawkins)

New York (State).  
Court of Chancery.

**J0071**

Index to miscellaneous files in  
Chancery, 1772-1847

Printed under authority of the Board of Regents  
of the State of New York, 1882

Index to miscellaneous files in Chancery, 1772-1847 (NYSA\_J0071-82\_Index)

New York (State).  
Court of Chancery.

**J1071**

Index to Chancery papers, 1800-1847

These cards (1800-1847) were prepared by the Board of Regents of the State of New York, 1882. They are arranged in alphabetical order of the names of the complainants, and are numbered in the order in which they were filed in the Court of Chancery. The names of the defendants are given in parentheses after the names of the complainants. The names of the parties are given in full, and are followed by the date of the filing of the papers. The names of the parties are given in full, and are followed by the date of the filing of the papers.

Index to Chancery Papers by complainant (NYSA\_J1071-82\_Index)



A survey for John Brandon of two lots of bark sold to Bartow G. Morss[?] & Peeled by him since 1840, No. 2 mostly on the



A Map of a survey made for John Brandon of a lot of Hemlock Bark sold to Bartow G. Morss[?] and peeled by him since 1840