

## Map of a portion of the shore line of Lake Placid and Paradox Bay

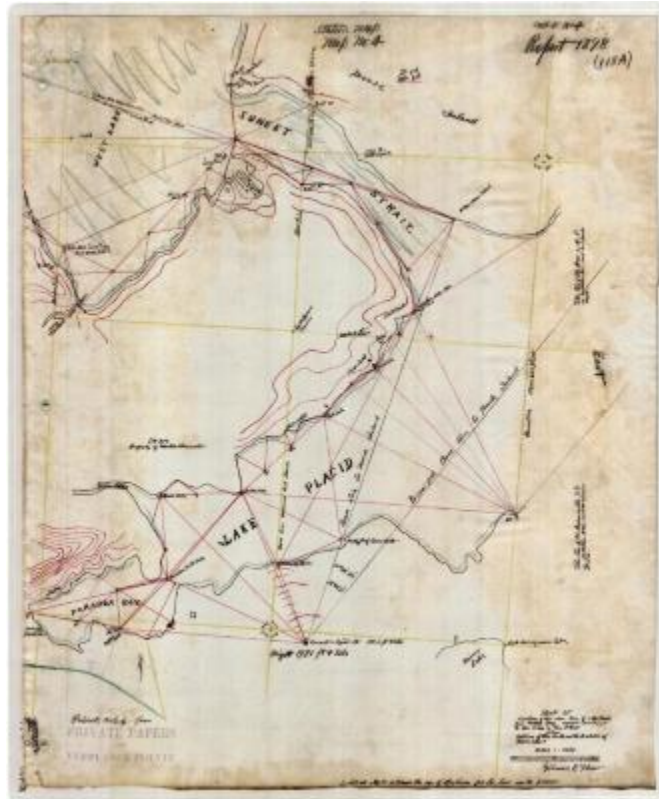

Hand drawn survey map of the shore line of Lake Placid and Paradox Bay. In addition to Lake Placid and Paradox Bay, the map shows the Sunset Strait, part of West Lake, part of Moose Island, and the Eastern shore of Mirror Lake. The map is marked, "Private copy from private papers of Verplanck Colvin." Original map is 18.3" x 22" inches and is held by the Dept. of Environmental Conservation.

### Identifier

NYSA\_B1405-96\_118A04A

### Alternate Identifier

DMS ID Number: 184669

### Date

1898

### Contributor

Colvin, Verplanck, 1847-1920

### Repository

New York State Archives

### Source

New York State Archives, Dept. of Environmental Conservation, Bureau of Real Property, Verplanck Colvin maps of the Adirondack wilderness

### Rights

This image is provided for education and research purposes. Rights may be reserved. Responsibility for securing permissions to distribute, publish, reproduce or other use rest with the user. For additional information see our [Copyright and Use Statement](#)

### Special Project

Environmental History Virtual Resource Collection

### More From This Series

Verplanck Colvin maps of the Adirondack wilderness

### Geographic Locations

Adirondack Mountains (is associated with)

Essex County (is associated with)