

Map Showing the Western Boundary Line of Totten and Crossfield's Purchase

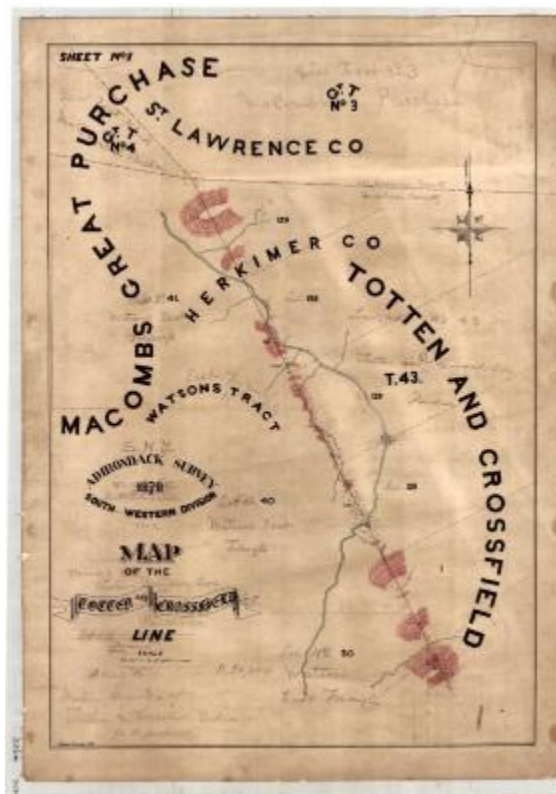

Hand drawn survey map of the Western boundary line of Totten and Crossfield's Purchase. The Western boundary line is the border between Totten and Crossfield's Purchase and Macomb's Great Purchase. The map also shows the county line between St. Lawrence and Herkimer Counties. The map also shows Watson's Tract and an unnamed river. The map is marked, "Private copy from private papers of Verplanck Colvin." Original map is 19.4" x 27.6" inches and is held by the Dept. of Environmental Conservation.

Identifier

NYSA_B1405-96_2B01

Alternate Identifier

DMS ID Number: 184773

Date

circa 1870 – 1899

Contributor

Colvin, Verplanck, 1847-1920

Repository

New York State Archives

Source

New York State Archives, Dept. of Environmental Conservation, Bureau of Real Property, Verplanck Colvin maps of the Adirondack wilderness

Rights

This image is provided for education and research purposes. Rights may be reserved. Responsibility for securing permissions to distribute, publish, reproduce or other use rest with the user. For additional information see our [Copyright and Use Statement](#)

Special Project

Environmental History Virtual Resource Collection

More From This Series

Verplanck Colvin maps of the Adirondack wilderness

Geographic Locations

Adirondack Mountains (is associated with)

Herkimer County (is associated with)

Saint Lawrence County (is associated with)

Hamilton County (is associated with)