

Map of 91,877 acres of land lately ceded to the State of New York by the St. Regis Indians. Made March 20th, 1826

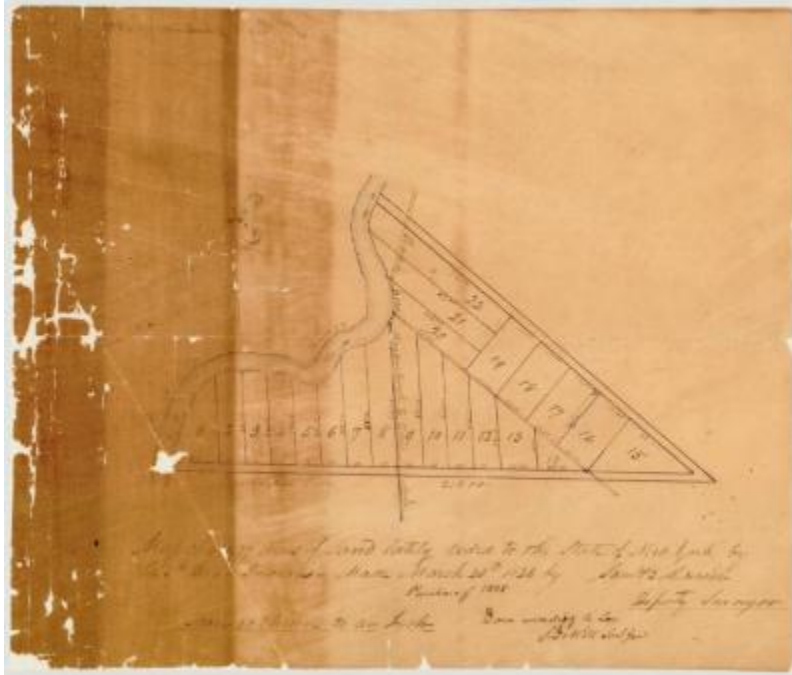

Map of twenty-two numbered lots with acreage, bordered a river with a road running through the middle. Land ceded to the State of New York by the St. Regis Indians. Made March 20th 1826. By Sam B. Anderson, Deputy Surveyor. Done according to law, S. DeWitt, Surveyor General. Scale of 20 chains to an inch. Original map size 25" x 38".

Identifier

NYSA_A0273-78_278_2

Alternate Identifier

DMS ID Number: 153328

Date

March 25 1826

Repository

New York State Archives

Source

New York State Archives, Series A0273-78, Survey maps of lands in New York State, [ca. 1711-1913] (bulk ca. 1772-1913), Map 278, part 2.

Rights

This image is provided for education and research purposes. Rights may be reserved. Responsibility for securing permissions to distribute, publish, reproduce or other use rest with the user. For additional information see our [Copyright and Use Statement](#)

More From This Series

Survey maps of lands in New York State

Geographic Locations

New York (is associated with)