

Map of unappropriated Land in the town of Westfield in the County of Washington. Map #50B

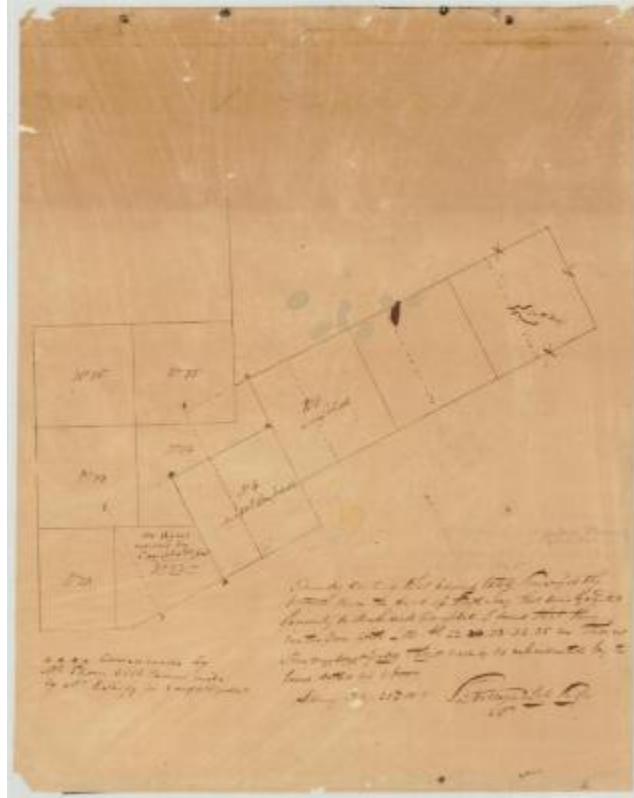

Map of unappropriated land in the town of Westfield in the County of Washington. Surveyed by order of the Surveyor General in the year 1803, by Stephen Thorn.

Identifier

NYSA_A0273-78_50B

Alternate Identifier

DMS ID Number: 182401

Date

1803

Contributor

Thorn, Stephen (surveyor)

Repository

New York State Archives

Source

New York State Archives. New York (State). State Engineer and Surveyor. Survey maps of lands in New York State, ca. 1711-1913. Series A0273-78, Map #50B.

Rights

This image is provided for education and research purposes. Rights may be reserved. Responsibility for securing permissions to distribute, publish, reproduce or other use rest with the user. For additional information see our [Copyright and Use Statement](#)

More From This Series

Survey maps of lands in New York State

Geographic Locations

Washington County (is associated with)