

Map of a certain tract of land in the County of Albany. Map #92

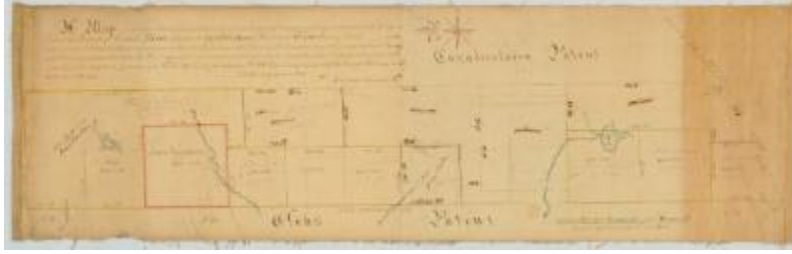

Map of a certain tract of land in the County of Albany, on the south side of the Sacondago [Sacandaga] branch of Hudson's river, between the Cayaderossera Patent and Glen's Patent. Surveyed by Lawrence Vrooman, Deputy Surveyor. Dated 23rd March, 1789. [Saratoga County]

Identifier

NYSA_A0273-78_92

Alternate Identifier

DMS ID Number: 182966

Date

March 23 1789

Contributor

Vrooman, Lawrence (surveyor)

Repository

New York State Archives

Source

New York State Archives. New York (State). State Engineer and Surveyor. Survey maps of lands in New York State, ca. 1711-1913. Series A0273-78, Map #92.

Rights

This image is provided for education and research purposes. Rights may be reserved. Responsibility for securing permissions to distribute, publish, reproduce or other use rest with the user. For additional information see our [Copyright and Use Statement](#)

More From This Series

Survey maps of lands in New York State

Geographic Locations

Saratoga County (is associated with)