

Map of Township No. 1, 2, 11 and 12 of Old Military Tract. Map #151

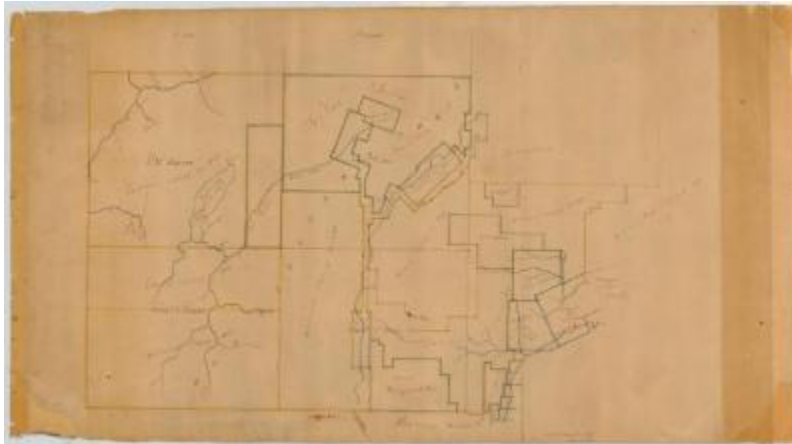

Map of Township No. 1, 2, 11 and 12 of Old Military Tract. Surveyor General's office, March 1813.

Identifier

NYSA_A0273-78_151

Alternate Identifier

DMS ID Number: 183370

Date

March 1813

Repository

New York State Archives

Source

New York State Archives. New York (State). State Engineer and Surveyor. Survey maps of lands in New York State, ca. 1711-1913. Series A0273-78, Map #151.

Rights

This image is provided for education and research purposes. Rights may be reserved. Responsibility for securing permissions to distribute, publish, reproduce or other use rest with the user. For additional information see our [Copyright and Use Statement](#)

More From This Series

Survey maps of lands in New York State

Geographic Locations

New York (is associated with)