

Map of a certain tract of land belonging to the State of New York (Copy). Copy of Map #159

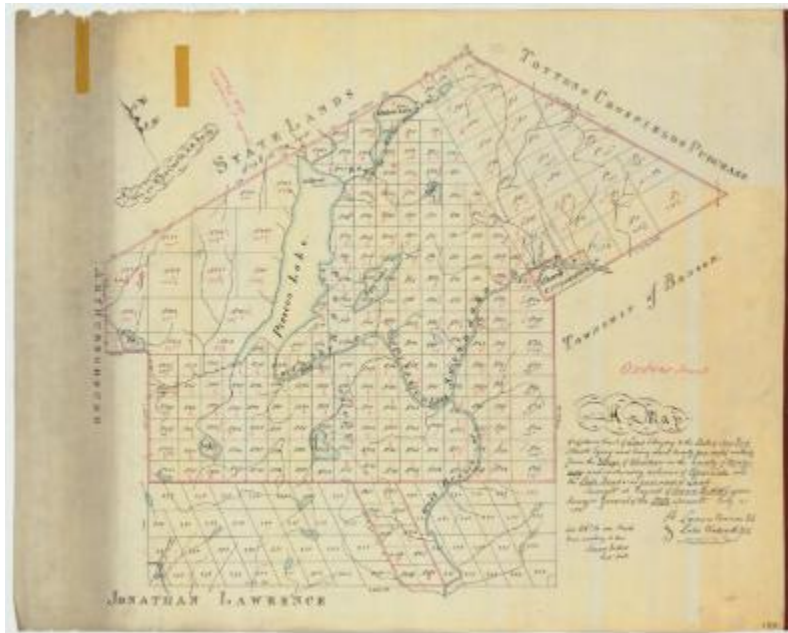

Copy of a Map of a certain tract of land belonging to the State of New York, situate, lying and being about twenty-four miles northerly from the village of Johnstown, in the County of Montgomery. Per Lawrence Vrooman, D. S. Luke Woodworth, D. S. [Ox Bow Tract, Hamilton County]

Identifier

NYSA_A0273-78_159_Copy

Alternate Identifier

DMS ID Number: 183531

Date

July 25 1811

Repository

New York State Archives

Source

New York State Archives. New York (State). State Engineer and Surveyor. Survey maps of lands in New York State, ca. 1711-1913. Series A0273-78, Map #159 (copy).

Rights

This image is provided for education and research purposes. Rights may be reserved. Responsibility for securing permissions to distribute, publish, reproduce or other use rest with the user. For additional information see our [Copyright and Use Statement](#)

More From This Series

Survey maps of lands in New York State

Geographic Locations

Hamilton County (is associated with)

Montgomery County (is associated with)