

Map of Randolph Township. Map #173

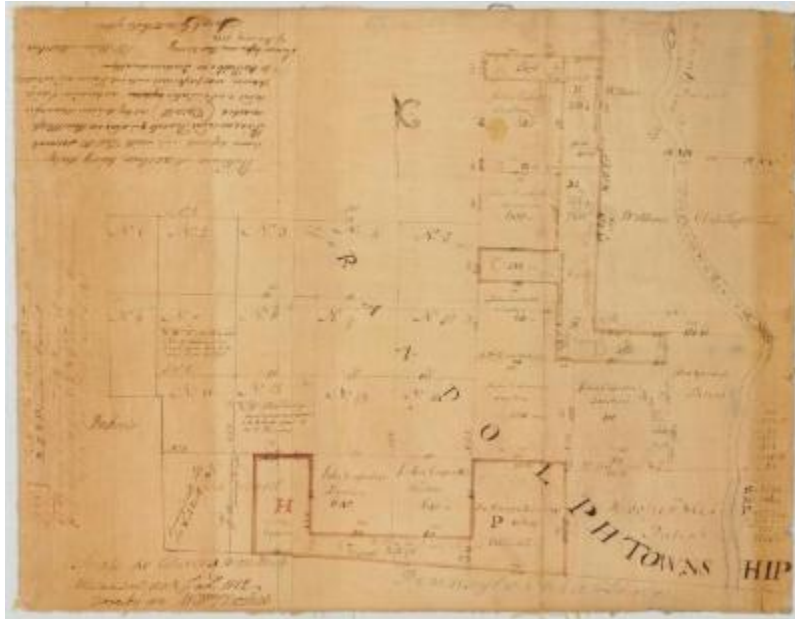

Map of Randolph Township. Broome County. William Macclure, Surveyor.

Identifier

NYSA_A0273-78_173

Alternate Identifier

DMS ID Number: 183678

Date

1811

Contributor

Macclure, William (surveyor)

Repository

New York State Archives

Source

New York State Archives. New York (State). State Engineer and Surveyor. Survey maps of lands in New York State, ca. 1711-1913. Series A0273-78, Map #173.

Rights

This image is provided for education and research purposes. Rights may be reserved. Responsibility for securing permissions to distribute, publish, reproduce or other use rest with the user. For additional information see our [Copyright and Use Statement](#)

More From This Series

Survey maps of lands in New York State

Geographic Locations

Broome County (is associated with)