

## Map of 201 Acres of land lying in the Town of Sullivan. Map #265

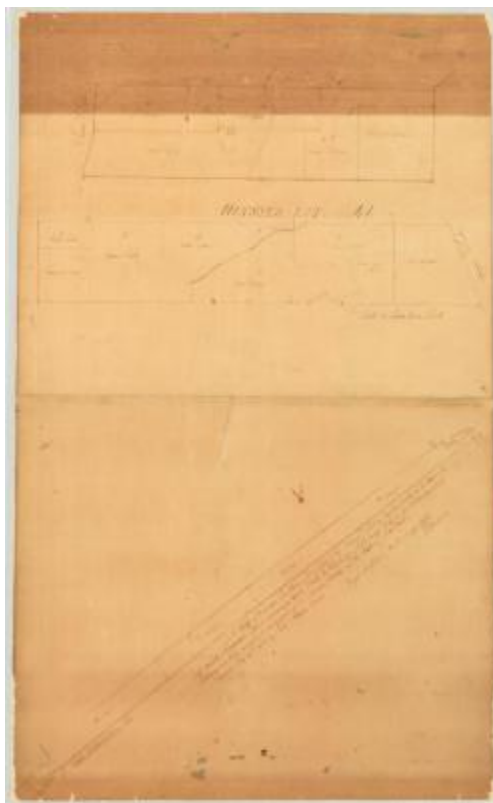

Map of 201 Acres 3 roods of land, lying in the Town of Sullivan, bounded north by the northwest part of the Oneida Reservation, east by the Canaseraga Creek, south by Varick and Bell's Patent, west by the Chittenengo Creek. Surveyed and lotted according to the directions of the Surveyor General of the State of New York. Surveyed December 29th, 1823, by John Adams, Surveyor. Also, Ovid Lot No. 75, Cayuga County, and Ulysses No. 41, Tompkins County.

**Identifier**

NYSA\_A0273-78\_265

**Alternate Identifier**

**DMS ID Number:** 184666

**Date**

December 29 1823

**Contributor**

Adams, John (surveyor)

**Repository**

New York State Archives

**Source**

New York State Archives. New York (State). State Engineer and Surveyor. Survey maps of lands in New York State, ca. 1711-1913. Series A0273-78, Map #265.

**Rights**

This image is provided for education and research purposes. Rights may be reserved. Responsibility for securing permissions to distribute, publish, reproduce or other use rest with the user. For additional information see our [Copyright and Use Statement](#)

**More From This Series**

Survey maps of lands in New York State

**Geographic Locations**

Tompkins County (is associated with)

Madison County (is associated with)