

Map of Carleton or Buck's Island on the river St. Lawrence. Map #266

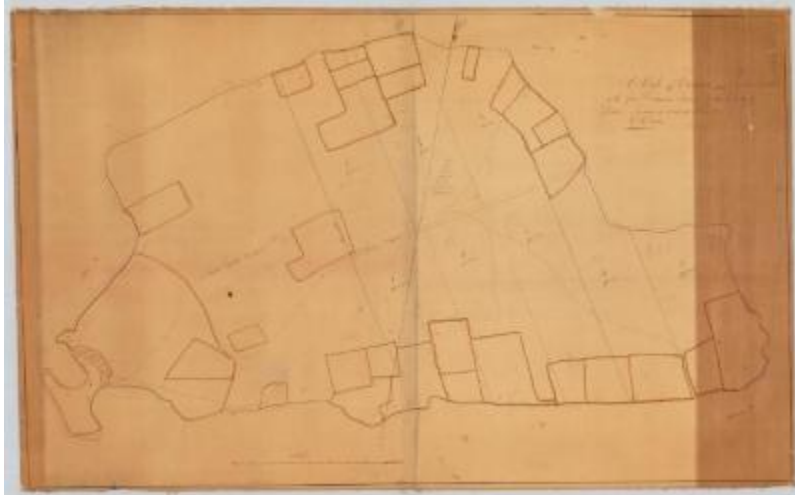

Map of Carleton or Buck's Island on the river St. Lawrence. Lyme, County of Jefferson. Surveyed and divided into lots in 1823. By F. R. Hassler.

Identifier

NYSA_A0273-78_266

Alternate Identifier

DMS ID Number: 184682

Date

1823

Contributor

Hassler, F.R. (surveyor)

Repository

New York State Archives

Source

New York State Archives. New York (State). State Engineer and Surveyor. Survey maps of lands in New York State, ca. 1711-1913. Series A0273-78, Map #266.

Rights

This image is provided for education and research purposes. Rights may be reserved. Responsibility for securing permissions to distribute, publish, reproduce or other use rest with the user. For additional information see our [Copyright and Use Statement](#)

More From This Series

Survey maps of lands in New York State

Geographic Locations

Jefferson County (is associated with)