

## Map and Survey of a tract of land appertaining to Fort Niagara. Map #469

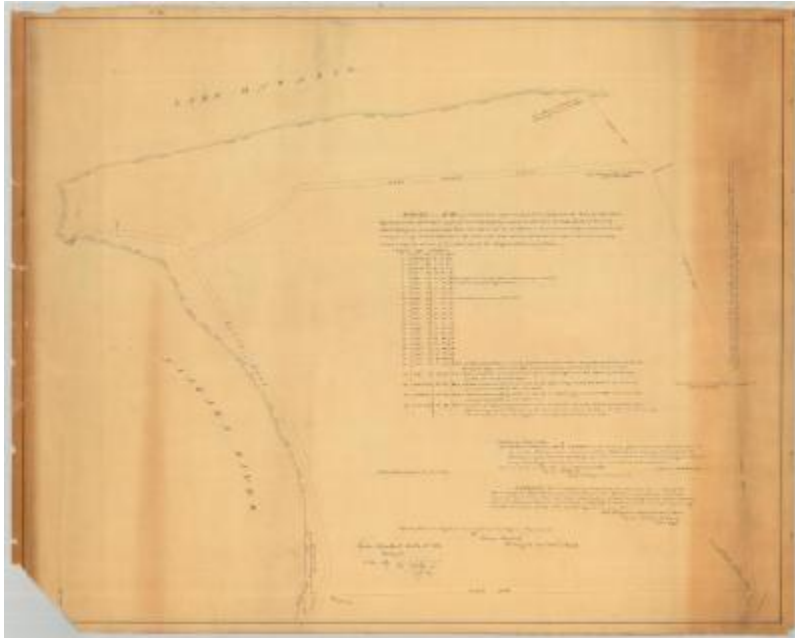

Map and Survey of a tract of land appertaining to Fort Niagara, in the State of New York. Made September, 1840 by J. P. Haines, Surveyor. [Niagara County]

**Identifier**

NYSA\_A0273-78\_469

**Alternate Identifier**

**DMS ID Number:** 185373

**Date**

1840

**Contributor**

Haines, J.P. (surveyor)

**Repository**

New York State Archives

**Source**

New York State Archives. New York (State). State Engineer and Surveyor. Survey maps of lands in New York State, ca. 1711-1913. Series A0273-78, Map #469.

**Rights**

This image is provided for education and research purposes. Rights may be reserved. Responsibility for securing permissions to distribute, publish, reproduce or other use rest with the user. For additional information see our [Copyright and Use Statement](#)

**More From This Series**

Survey maps of lands in New York State

**Geographic Locations**

Niagara County (is associated with)