

Cosby's Manor or land of Joseph Worrell and John Lyne. Map #621

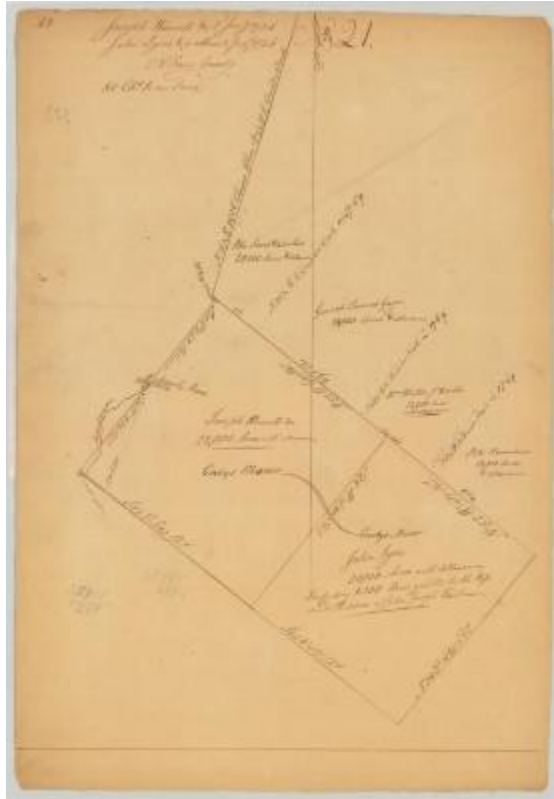

Cosby's Manor, 42,000 acres on Mohawk River, or land of Joseph Worrell, 22,000 acres, and John Lyne, 20,000 acres. Albany County.

Identifier

NYSA_A0273-78_621

Alternate Identifier

DMS ID Number: 186393

Date

1734

Repository

New York State Archives

Source

New York State Archives. New York (State). State Engineer and Surveyor. Survey maps of lands in New York State, ca. 1711-1913. Series A0273-78, Map #621.

Rights

This image is provided for education and research purposes. Rights may be reserved. Responsibility for securing permissions to distribute, publish, reproduce or other use rest with the user. For additional information see our [Copyright and Use Statement](#)

More From This Series

Survey maps of lands in New York State

Geographic Locations

Albany County (is associated with)

Mohawk River (is associated with)