

## Map of the Gore lying between the Old Military Tract and the Canadian and Nova Scotia Refugee Tract. Map #300

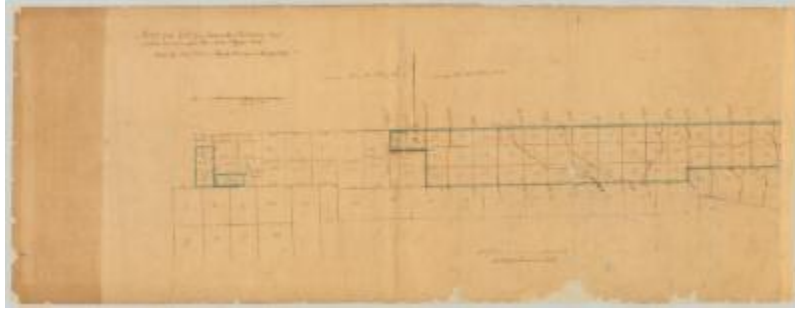

Map of the Gore lying between the Old Military Tract and the Canadian and Nova Scotia Refugee Tract. Made by John Richards, Deputy Surveyor, in the year 1829.

**Identifier**

NYSA\_A0273-78\_300

**Alternate Identifier**

**DMS ID Number:** 184790

**Date**

1829

**Contributor**

Richards, John (surveyor)

**Repository**

New York State Archives

**Source**

New York State Archives. New York (State). State Engineer and Surveyor. Survey maps of lands in New York State, ca. 1711-1913. Series A0273-78, Map #300.

**Rights**

This image is provided for education and research purposes. Rights may be reserved. Responsibility for securing permissions to distribute, publish, reproduce or other use rest with the user. For additional information see our [Copyright and Use Statement](#)

**More From This Series**

Survey maps of lands in New York State

**Geographic Locations**

New York (is associated with)