

Survey of land for Philip Livingston and John Lindesay. Map #633

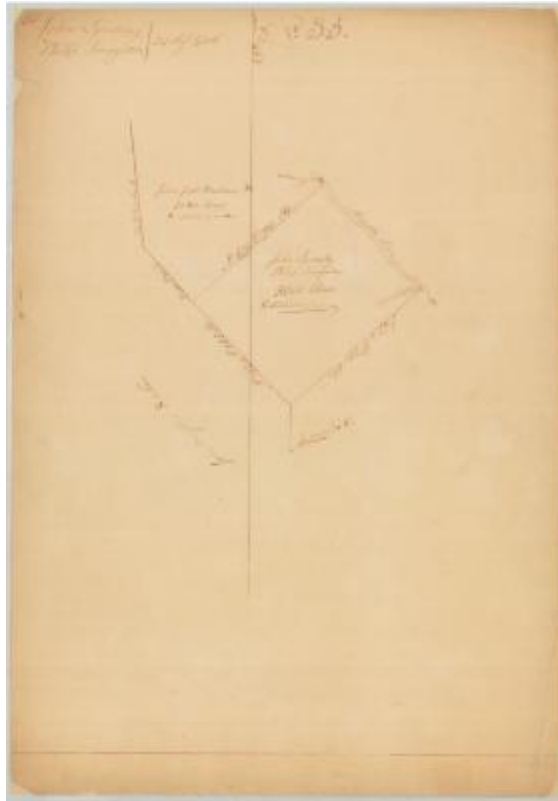

Survey of land for Philip Livingston and John Lindesay, 3,000 acres, south side of Hudson river, August, 1736.

Identifier

NYSA_A0273-78_633

Alternate Identifier

DMS ID Number: 186487

Date

1736

Repository

New York State Archives

Source

New York State Archives. New York (State). State Engineer and Surveyor. Survey maps of lands in New York State, ca. 1711-1913. Series A0273-78, Map #633.

Rights

This image is provided for education and research purposes. Rights may be reserved. Responsibility for securing permissions to distribute, publish, reproduce or other use rest with the user. For additional information see our [Copyright and Use Statement](#)

More From This Series

Survey maps of lands in New York State

Geographic Locations

Hudson River (is associated with)