

## Survey of land for Lawrence Kortright, John Harpur and Arent Bradt. Map #659

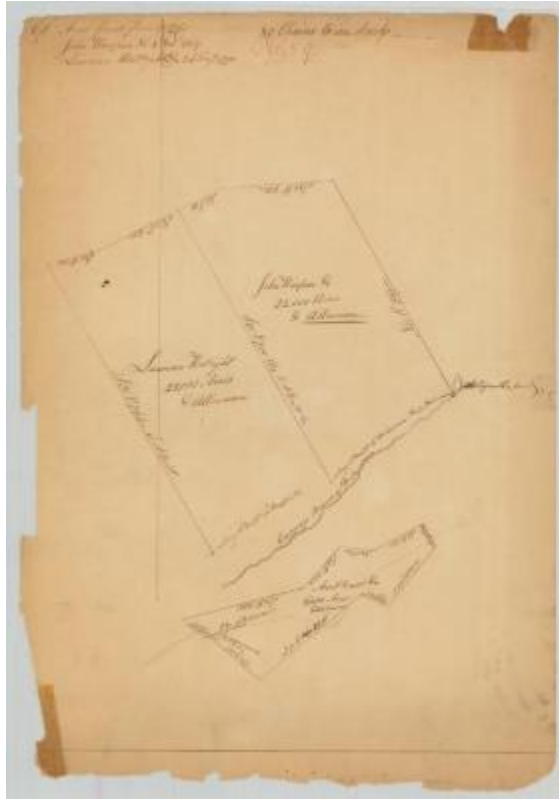

Survey of land for Lawrence Kortright, 22,000 acres (February 24, 1770), John Harpur, 22,000 acres (December 8th, 1769) and Arent Bradt and others, 6,000 acres (June 31st, 1740) on the Coogquago branch of the Delaware river.

### Identifier

NYSA\_A0273-78\_659

### Alternate Identifier

DMS ID Number: 186528

### Date

1740 – 1770

### Repository

New York State Archives

### Source

New York State Archives. New York (State). State Engineer and Surveyor. Survey maps of lands in New York State, ca. 1711-1913. Series A0273-78, Map #659.

### Rights

This image is provided for education and research purposes. Rights may be reserved. Responsibility for securing permissions to distribute, publish, reproduce or other use rest with the user. For additional information see our [Copyright and Use Statement](#)

### More From This Series

Survey maps of lands in New York State

### Geographic Locations

New York (is associated with)