

Survey of land for John Thompson and others. Map #716

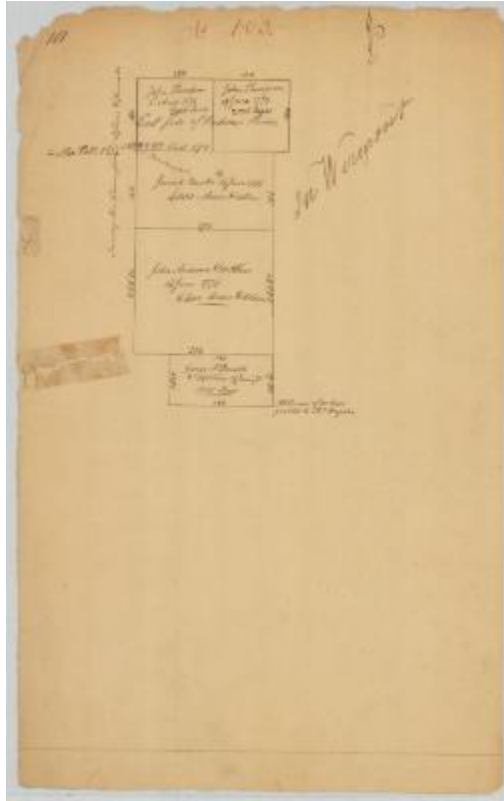

Survey of land for John Thompson and others said to be in Vermont.

Identifier

NYSA_A0273-78_716

Alternate Identifier

DMS ID Number: 186588

Date

1750 – 1775

Repository

New York State Archives

Source

New York State Archives. New York (State). State Engineer and Surveyor. Survey maps of lands in New York State, ca. 1711-1913. Series A0273-78, Map #716.

Rights

This image is provided for education and research purposes. Rights may be reserved. Responsibility for securing permissions to distribute, publish, reproduce or other use rest with the user. For additional information see our [Copyright and Use Statement](#)

More From This Series

Survey maps of lands in New York State

Geographic Locations

Vermont (is associated with)

New York (is associated with)