

Land of Isaac Paris, 2,400 acres, John Zabriskie, 2,500 acres and others. Map #731

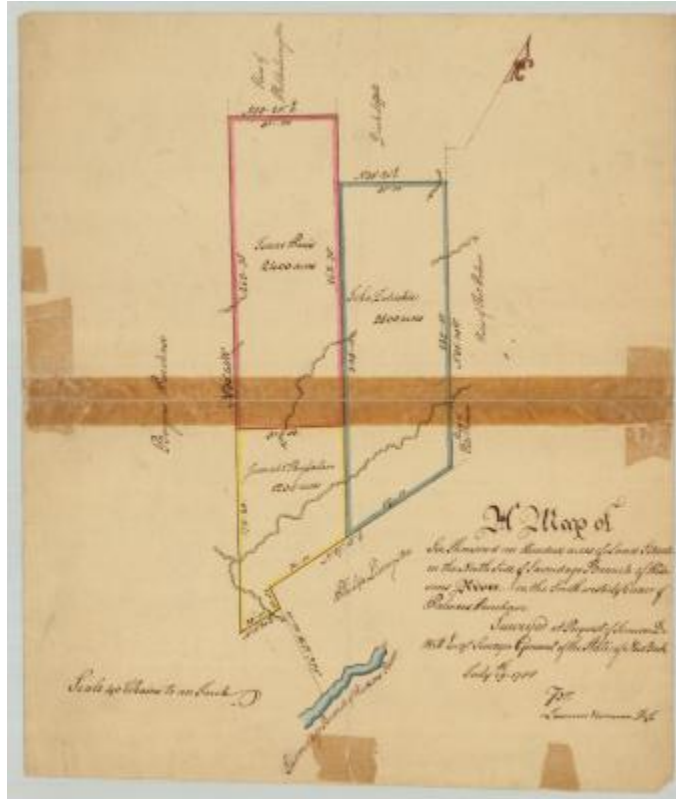

Land of Isaac Paris, 2,400 acres, John Zabriskie, 2,500 acres and J. Van Rensselaer, 1,200 acres in the southwest corner of Palmer's Purchase. By L. Vroman. July, 1788.

Identifier

NYSA_A0273-78_731

Alternate Identifier

DMS ID Number: 186604

Date

1788

Contributor

Vroman, L. (surveyor)

Repository

New York State Archives

Source

New York State Archives. New York (State). State Engineer and Surveyor. Survey maps of lands in New York State, ca. 1711-1913. Series A0273-78, Map #731.

Rights

This image is provided for education and research purposes. Rights may be reserved. Responsibility for securing permissions to distribute, publish, reproduce or other use rest with the user. For additional information see our [Copyright and Use Statement](#)

More From This Series

Survey maps of lands in New York State

Geographic Locations

Staten Island (is associated with)