

A Survey of Lot No. 9, Whitesborough, Town of Delhi, Delaware County

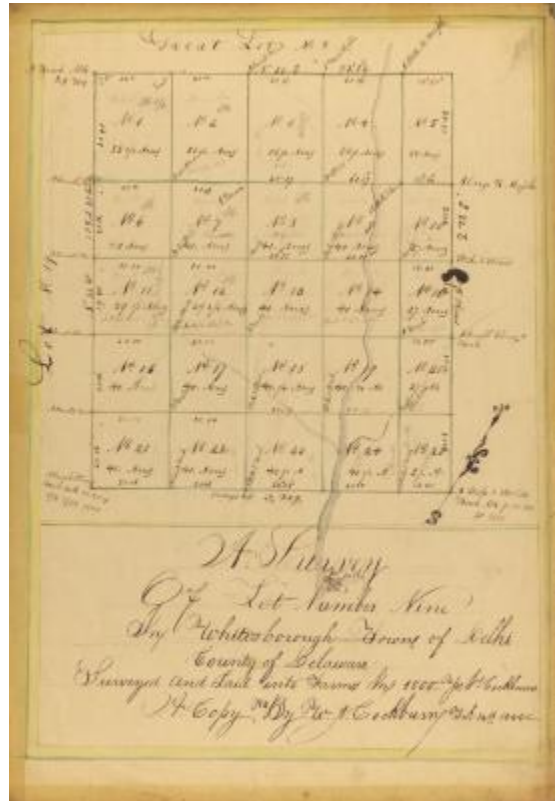

Survey of Lot No.9, Whitesborough, Town of Delhi, Delaware County, in the Catskill Mountains. Surveyed and laid into farms by James Cockburn, 1800.

Identifier

NYSA_B1773-01_B3_F14

Alternate Identifier

DMS ID Number: 117369

Date

February 14 1845

Repository

New York State Archives

Source

New York State Archives, Cockburn Field Notes, Land Records and Maps, B1773-01, Box 3, Folder 14

Rights

This image is provided for education and research purposes. Rights may be reserved. Responsibility for securing permissions to distribute, publish, reproduce or other use rest with the user. For additional information see our [Copyright and Use Statement](#)

More From This Series

Cockburn field notes, land records, and maps

Geographic Locations

Catskill Mountains (is associated with)

Delaware County (is associated with)