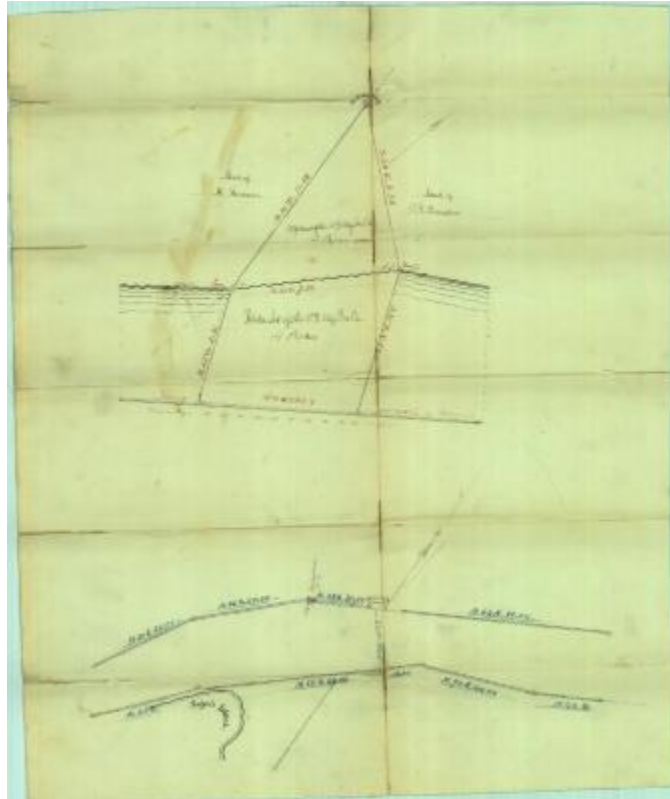

Survey of lands under water for Washington Ice Company

**Identifier**

NYSA_B2321-11_18690612_Washington_Ice_Co

Date

June 12 1869

Contributor

Washington Ice Company (Applicant)

Repository

New York State Archives

Source

New York State Archives, New York State Office of General Services Division of Land Utilization lands under water application files, Series B2321, Box 6.

Rights

This image is provided for education and research purposes. Rights may be reserved. Responsibility for securing permissions to distribute, publish, reproduce or other use rest with the user. For additional information see our [Copyright and Use Statement](#)

More From This Series

Lands under water application files

Geographic Locations

Greene County (is associated with)